

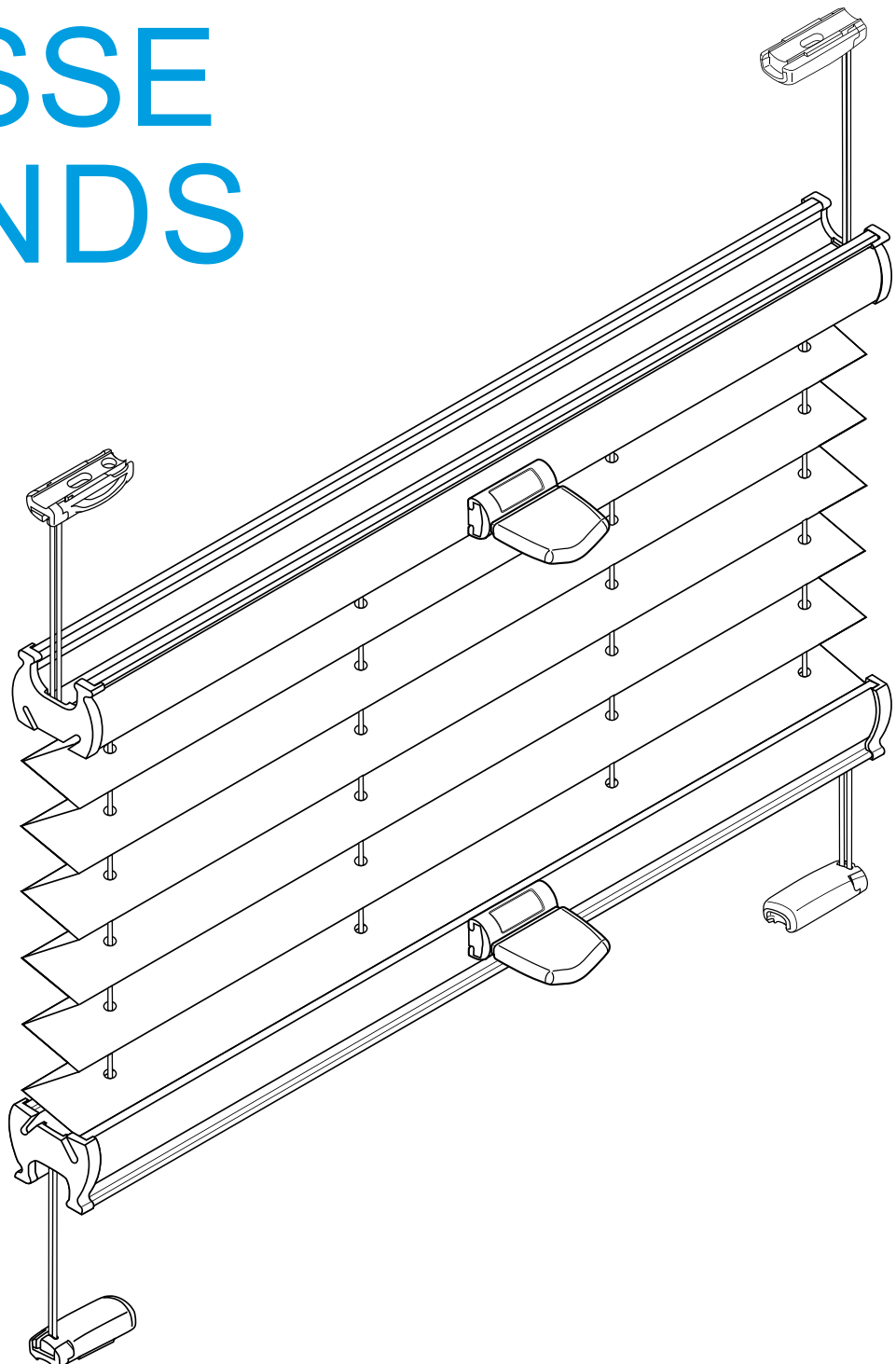

Labona

TECHNICAL MANUAL

PLISSE BLINDS



Pleated blinds

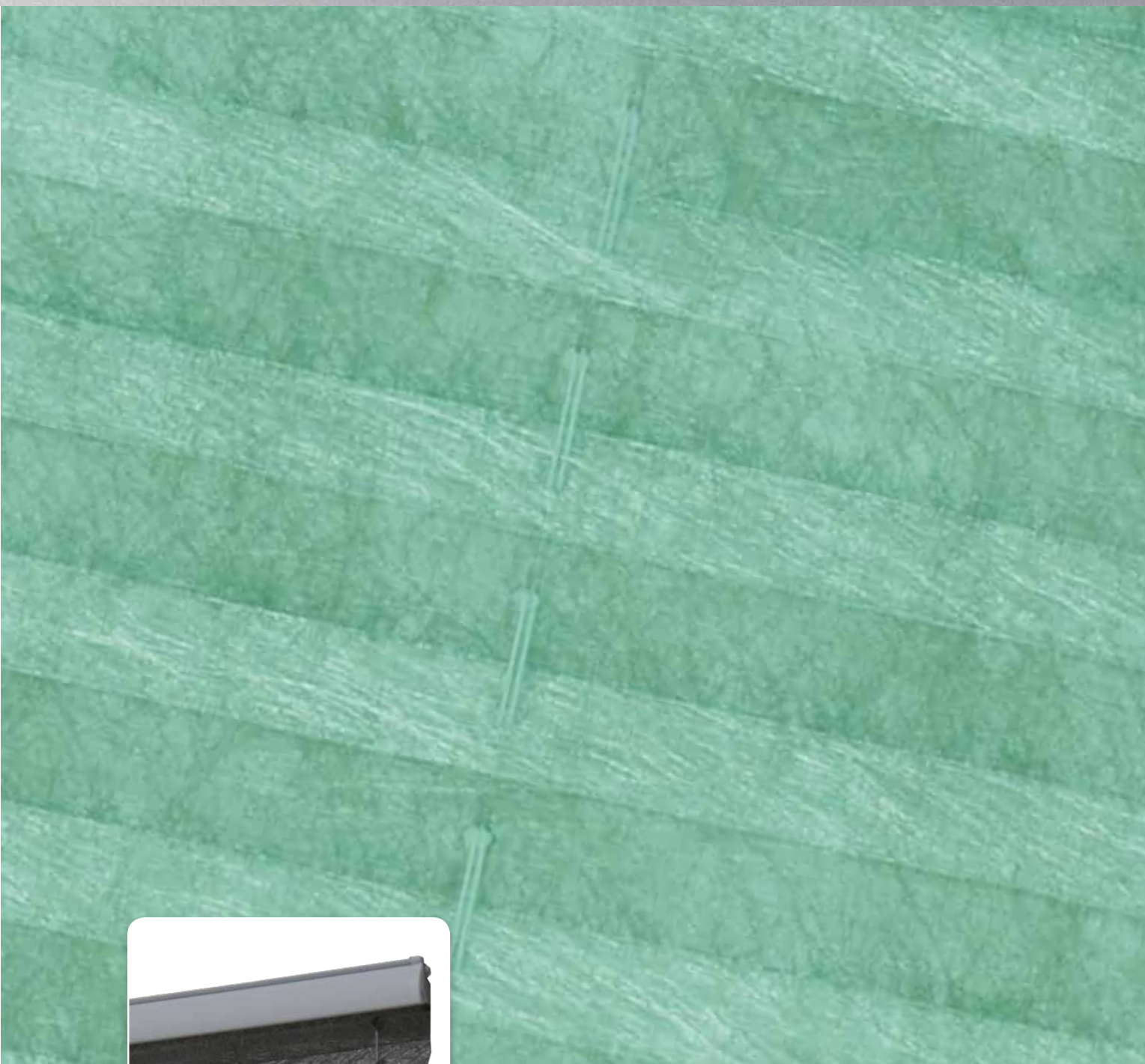

- ▲ Elegant element of modern interior
- ▲ Many atypical shapes
- ▲ Wide range of pleated materials, colors, patterns and printing
- ▲ Fabrics with various light permeability, black-out fabrics, reflective fabrics and PEARL fabrics
- ▲ Optional combination of two fabrics
- ▲ Variable control system – cord, handle, profile

ISOTRA *Quality*

Color

Head and bottom rail



white 01



silver 02



black-brown 05



anthracite 12

Plastic Components



white



grey



black

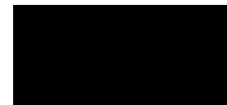

black

Other RAL and DECORAL colors of profile are at extra charge.

Control

Control by profile

(for types DFC pleated blinds)



Control by operating rod

(for DFC pleated blinds)



Care Instructions for Pleated Blinds

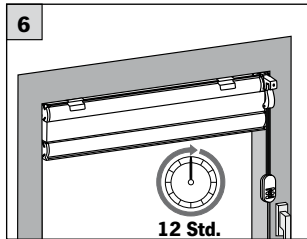
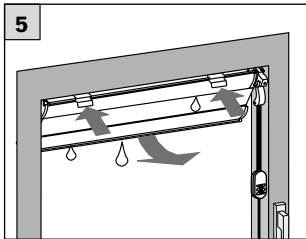
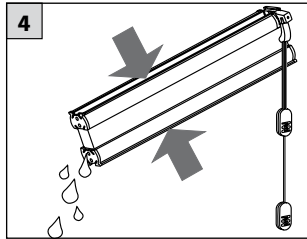
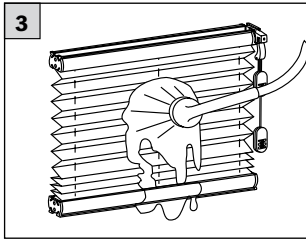
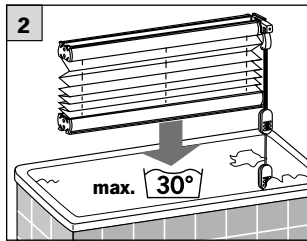
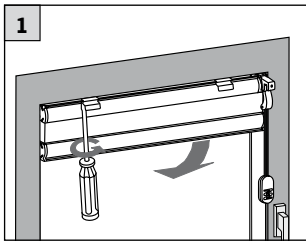

Pleated fabrics are easy to clean.

- Simply wash the blind in a solution of warm water of max. 30°C and a mild detergent. Rinse thoroughly, push the fabric into stack and carefully squeeze the water out until the blind does not drip any longer. Hang the blind up in closed position. Open and close the blind several times while allowing it to dry to prevent the pleats sticking together. DO NOT IRON!

- This excludes all metallised fabrics as well as coated black out fabrics and B1-qualities. These can be carefully wiped clean with a cloth. Do not rub!

- We advise against chemical or ultrasonic cleaning and do not accept warranty claims in such cases.

- We advise against chemical or ultrasonic cleaning and do not accept warranty claims in such cases.

Product Information

Operation

For a long-lasting pleating it is necessary to operate your pleated blind regularly and also to fully raise the blind for longer periods.

Especially when the pleated blind is exposed to high temperatures (eg southfacing windows, roof-lights, conservatories etc.), above practise is important to repeatedly support the pleats.

Cleaning Frames and Glass

- For cleaning window frames and glasspanes do not use any caustic or alkaline detergents which may encounter directly or indirectly (condensation water) with the blind.
- Insufficient air ventilation (please see fitting instructions for min. mounting spaces) can cause condensation water.
- Warranty does not apply to damages to the fabric caused by dripping water or insect excrements.

Exterior Usage

Pleated blinds are designed for heated interior locations only and not for exterior usage or swimming baths.

Therefore no warranty is given for exterior installations, on open or partly glazed roofed areas or swimming baths.

Photometric values of pleated blinds

The properties of pleated blinds in connection with light depend on many factors - for example, weave, coating, yarn selection, color, etc. These factors influence the optical and thermo-technical effects and ensure that each fabric has different lighting values.

The photometric values are spread on reflection, absorption and transmission. Together they add up to 100%. (Influences by ventilation, glass, assembly and assemble distance are not considered).

Explanation of Terms

Example: Fabric no 10114

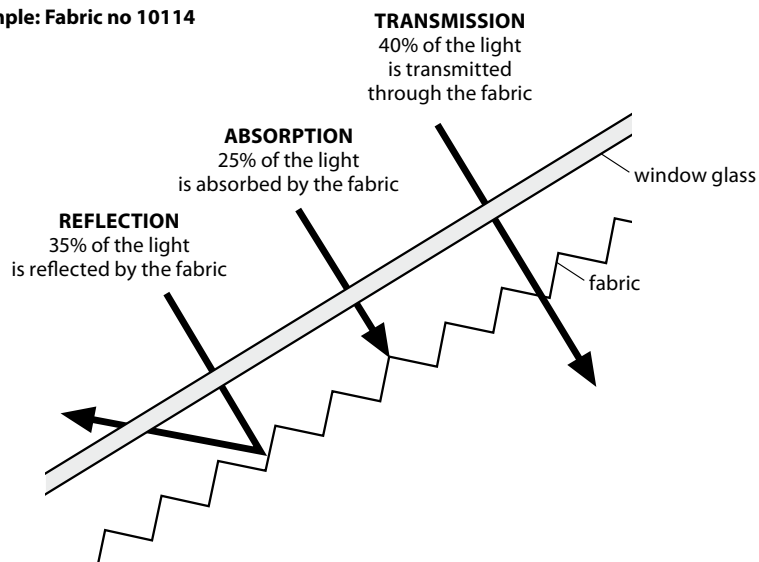

Reflection: The value of reflection indicates the amount of light reflected from the fabric. The more sunlight is reflected, the less it will remain in the room and the room is not so heated.

Transmission - The value of transmission indicates the amount of light passing through the fabric. The higher the transmission value, the brighter the room.

Absorption - The value of absorption indicates the amount of light absorbed by the fabric. The absorbed light energy is usually converted into heat.

Pleated blinds for Computer Workplaces

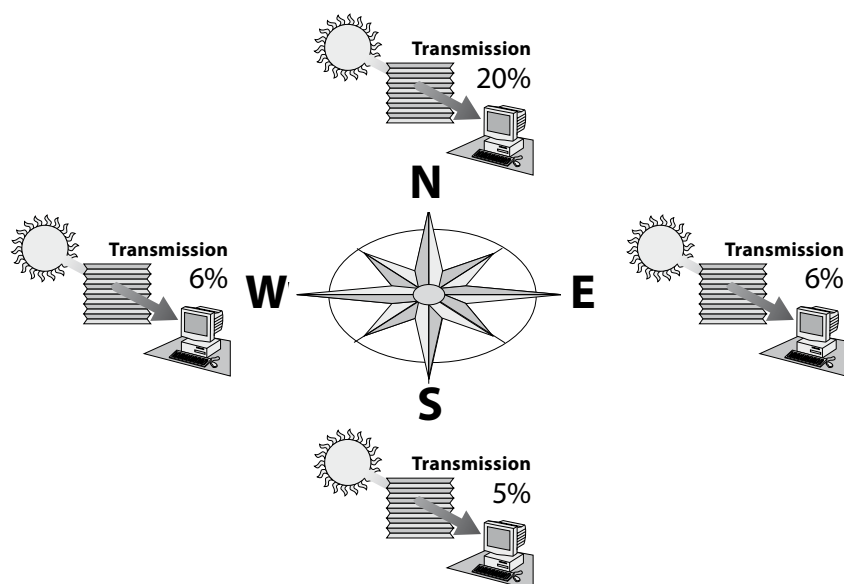

The intensity of sunlight varies from each of the four directions.

Interior sunshades are designed to reduce the incoming sunlight.

The maximum permissible transmission level according to EU guidelines is given as percentage for all four directions.

Roof pleated blinds DFC

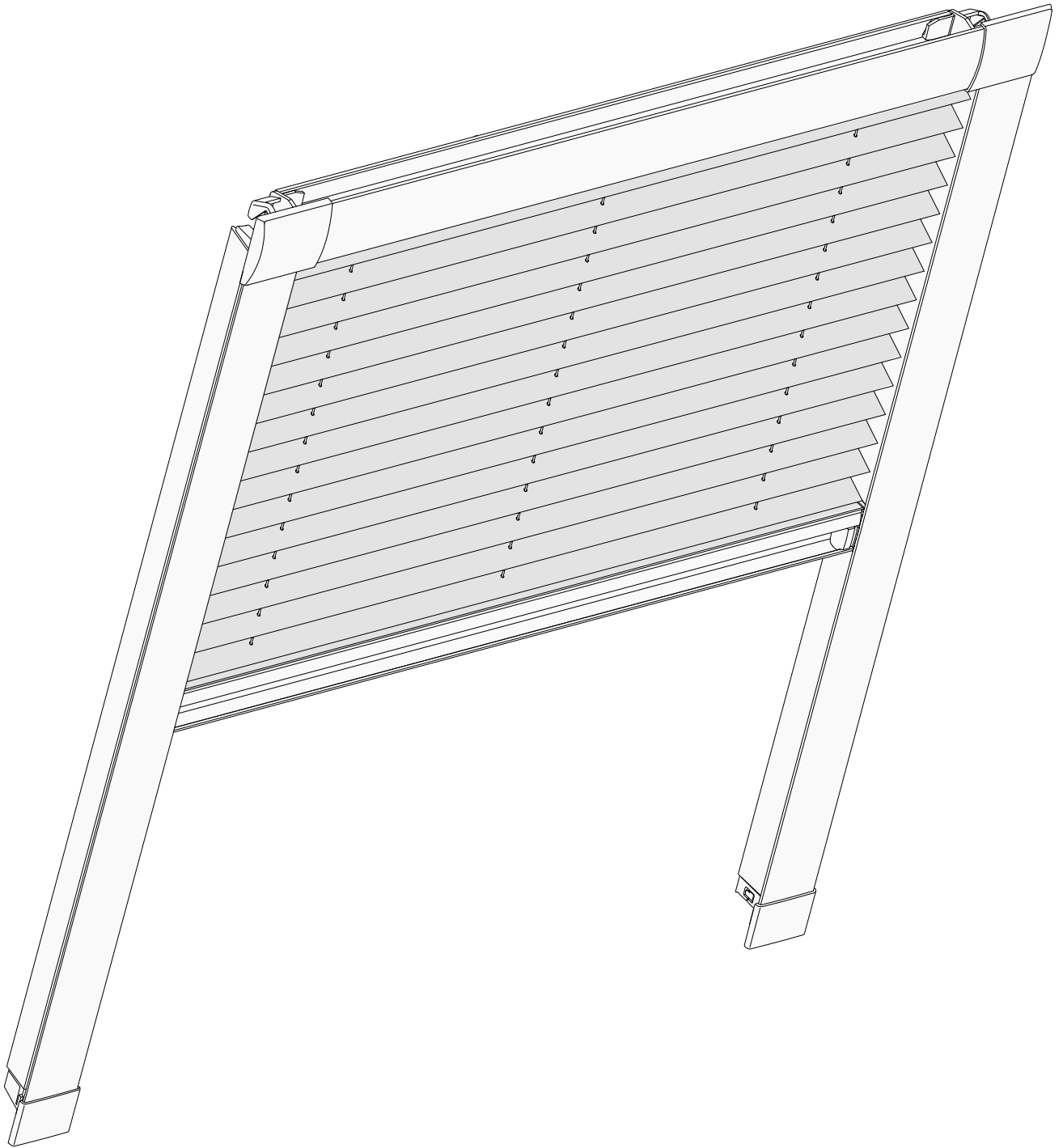

Basic Product Specification

Pleated blind "Type DFC 10"

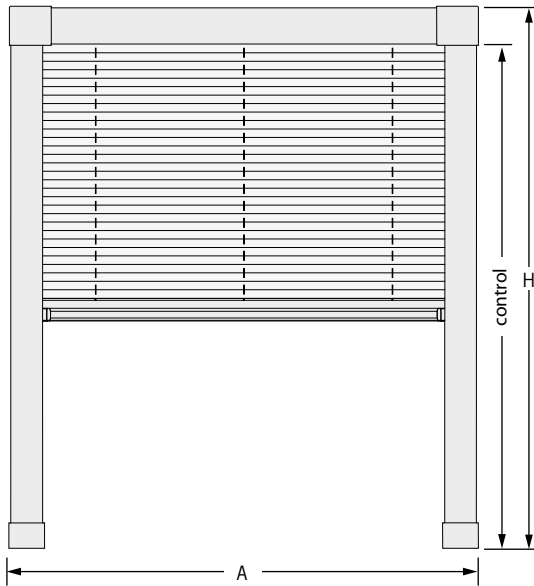

Fitting Situations:
Angled

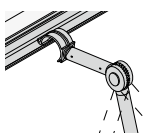

Note

- Possible with operating rod.
- For windows with angled or straight frames.
- DFC only available for assembly in the beading.

Limit dimensions of pleated blinds

Width (A)		Height (H)	
min	max	min	max
250 mm	1500 mm	400 mm	1500 mm
to width 1200 mm max. 1900 mm			

Limit dimensions of honeycomb pleated blinds

Width (A)		Height (H)	
min	max	min	max
250 mm	1500 mm	400 mm	1500 mm
to width 1200 mm max. 1900 mm			

Package Height

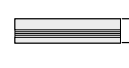
Blind Height	Package Height
	
500 mm	ca. 70 mm
1000 mm	ca. 80 mm
1500 mm	ca. 90 mm

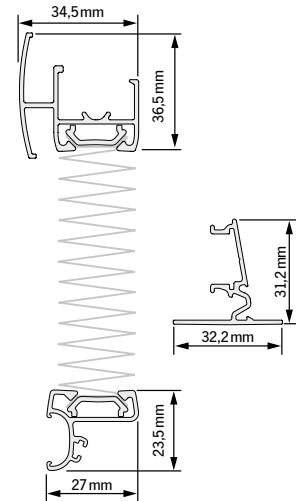

Profiles Color

- white
- black-brown
- silver

Pleated blind "Type DFC 20"

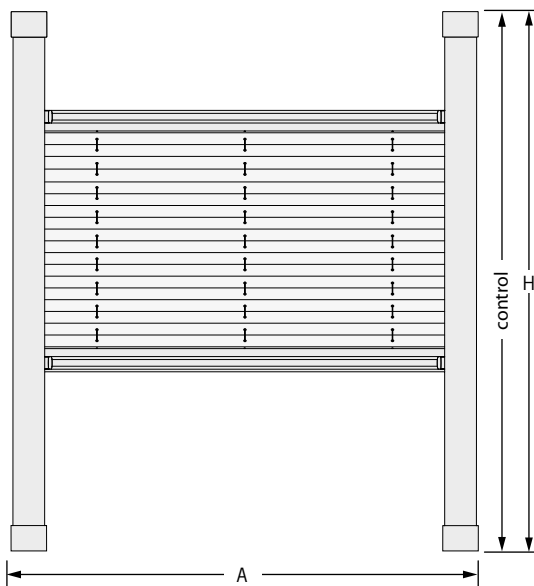

Fitting Situations:
Angled

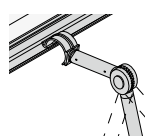

Note

- Possible with operating rod.
- For windows with angled or straight frames.
- DFC only available for assembly in the beading.

Limit dimensions of pleated blinds

Width (A)		Height (H)	
min	max	min	max
250 mm	1500 mm	400 mm	1500 mm
to width 1200 mm max. 1900 mm			

Limit dimensions of honeycomb pleated blinds

Width (A)		Height (H)	
min	max	min	max
250 mm	1500 mm	400 mm	1500 mm
to width 1200 mm max. 1900 mm			

Package Height

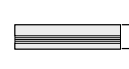
Blind Height	Package Height
	
500 mm	ca. 60 mm
1000 mm	ca. 70 mm
1500 mm	ca. 80 mm

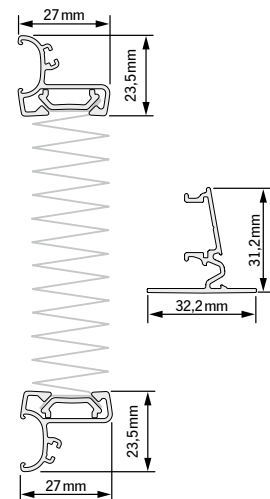

Profiles Color

- white
- black-brown
- silver

Pleated blind "Type DFC 30"

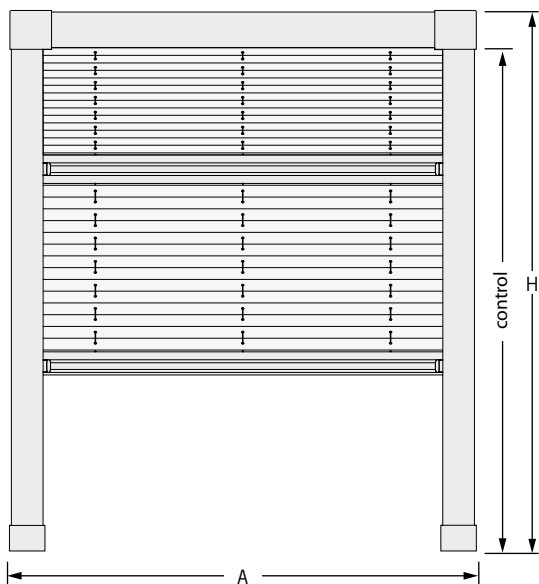

Fitting Situations:
Angled

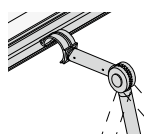

Note

- Possible with operating rod.
- For windows with angled or straight frames.
- DFC only available for assembly in the beading.
- In case of using two fabrics the order of substances is always set such that the fabric with heavier weight is always basic fabric placed in upper part of the blind, and the fabric with lower weight is always additional fabric places in lower part of the blind.

Limit dimensions of pleated blinds

Width (A)		Height (H)	
min	max	min	max
250 mm	1500 mm	400 mm	1500 mm
to width 1200 mm max. 1900 mm			

Limit dimensions of honeycomb pleated blinds

Width (A)		Height (H)	
min	max	min	max
250 mm	1500 mm	400 mm	1500 mm
to width 1200 mm max. 1900 mm			

Package Height

Blind Height	Package Height
500 mm	ca. 100 mm
1000 mm	ca. 120 mm
1500 mm	ca. 140 mm

Profiles Color

- white
- black-brown
- silver

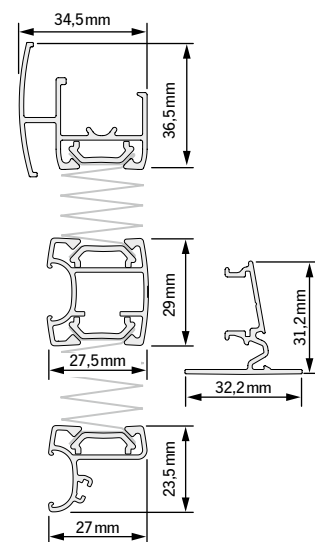

Measuring and assembly of pleated blinds DFC

Standardised roof windows

roof windows Velux

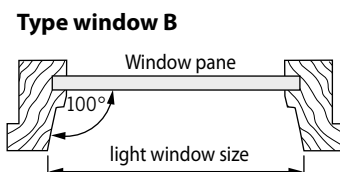
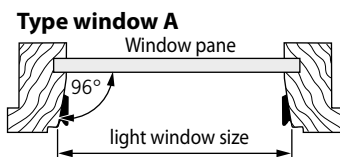

Assembly of pleated blinds si always done to the frame.

Over the years Velux changed several types of windows, without issuing new label types.

Please specify:

- **window brand**

- **type** (e.g. GGL)

- **dimensions** (e.g. FK06)

In addition to this, please provide a **light window dimensions** as the checking dimensions, measured at the front edge (see drawing).

Attention: type DFC can not be assembled to windows GGL produced in June 2000.

roof windows Roto

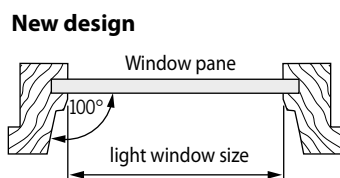
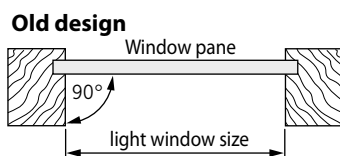

Assembly of pleated blinds si always done to the frame.

Company Roto produces 2 types of window frames.

Please specify:

- **window brand**

- **type** (e.g. R7)

- **dimensions** (e.g. 7/11)

In addition to this, please provide a **light window dimensions** as the checking dimensions.

Please note that the light dimensions are measured at the narrowest point for Roto windows (see drawing).

roof windows Braas/Blefa/Dörken

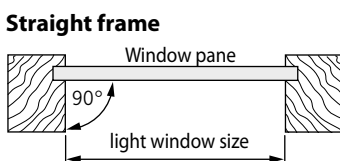

Attention: Pleated blinds DFC with handle can not be assembled to roof windows produced by these companies.

roof windows Fakro

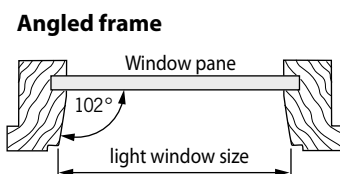

Assembly of pleated blinds si always done to the frame.

Please specify:

- **window brand**

- **type** (e.g. FTS)

- **dimensions** (e.g. 66/98)

In addition to this, please provide a **light window dimensions** as the checking dimensions.

Non-Standardised roof windows

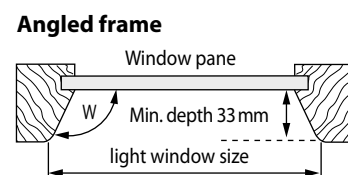
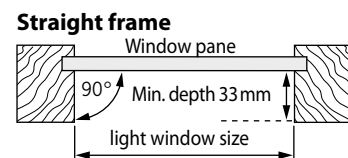

Note

Assembly of pleated blinds si always done to the frame. Please specify the **light dimensions of window** measured at the front edge (see drawing). In addition to this, please specify bevel frame, bevel angle between window pane and window frame.

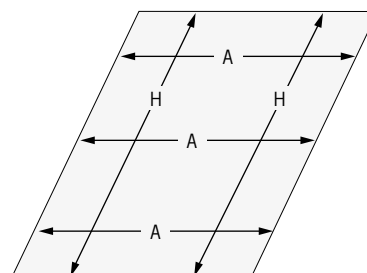

Measure at several points in case of possible frame size tolerances.