

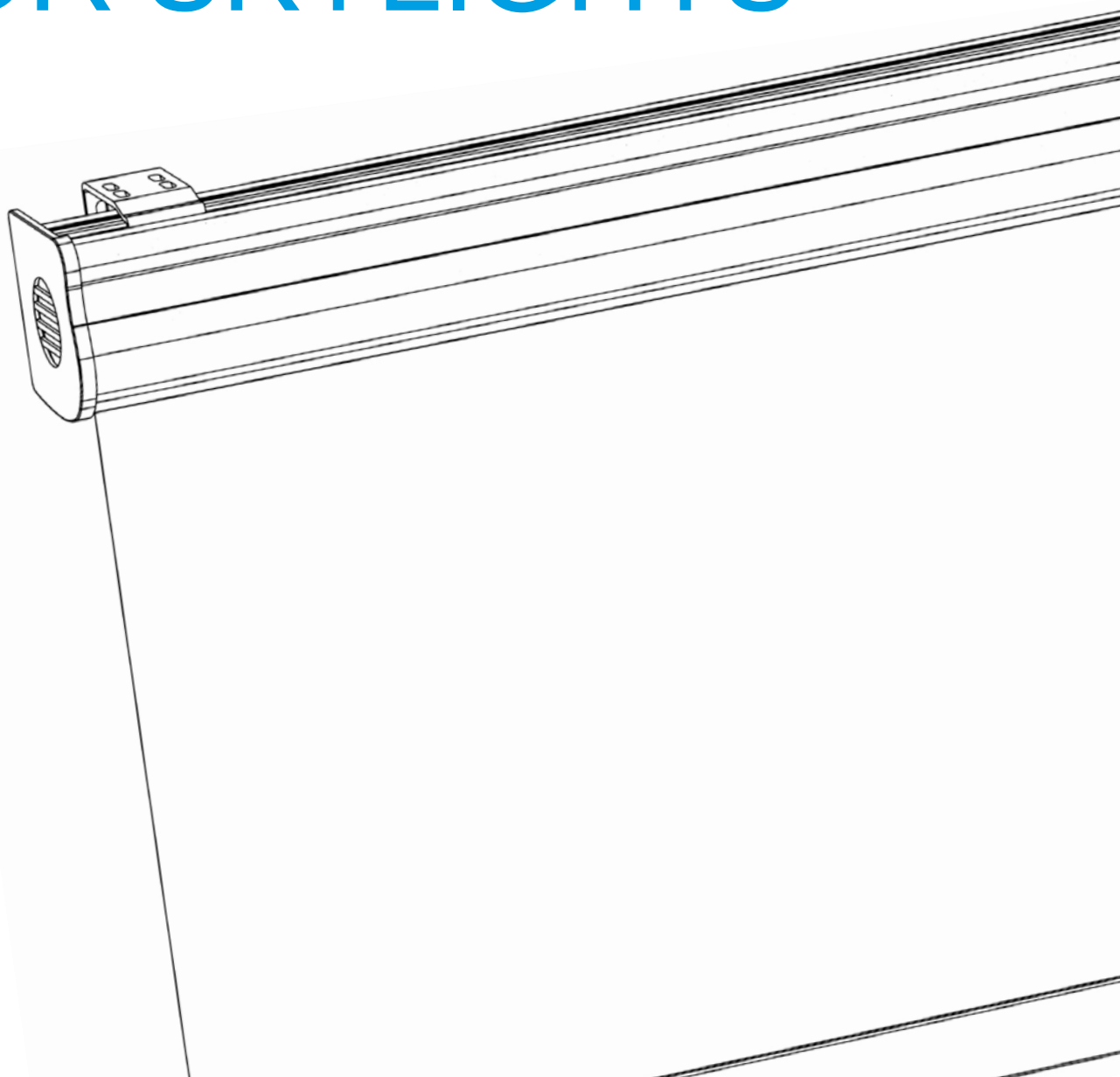

Labona

TECHNICAL MANUAL

ROLLER SHADE FOR SKYLIGHTS



R-Lite



- ▲ Perfect interior shading
- ▲ Applicable to all skylight types
- ▲ Guiding rails prevent light penetration at the window sides
- ▲ Profiles and guiding rails made of anodized aluminum or in white color
- ▲ Easy control with a wand for windows difficult to access

ISOTRA *Quality*

R-Lite Interior Roller Blind

Basic Product Specification

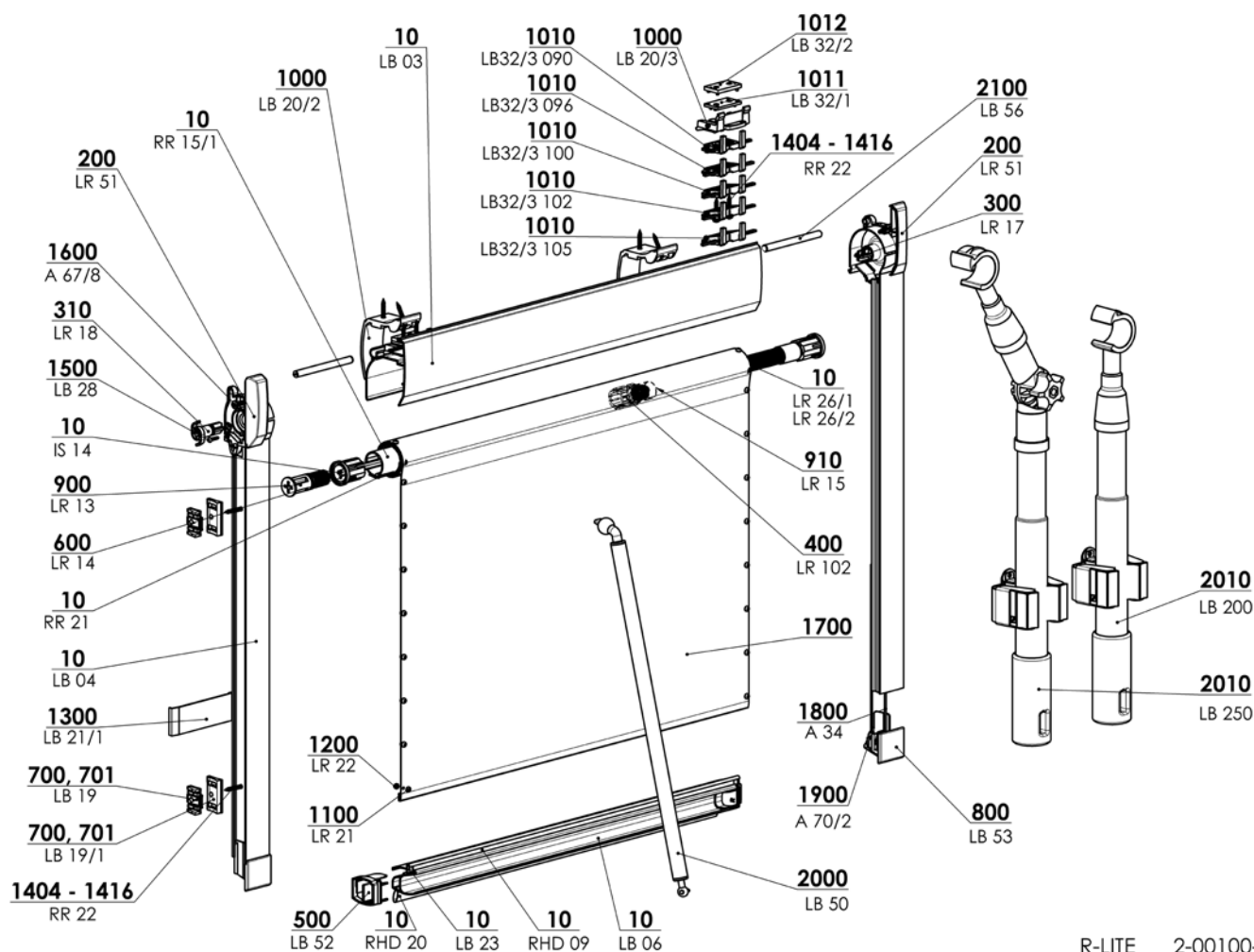

R-LITE 2-00100-XXXX-E

Manual Control

Pulling the roller blind up and down by gripping the bottom rail. The roller blinds on high windows are controlled with a wand.

Fixed wand:



Standard: 50 cm, 100 cm, 150 cm, 200 cm

Color: elox

Telescopic wand with hook / with joint and hook:

Color: grey with black components

Specification

	Head rail	Bottom rail	Guiding rail	Brake	Assembly
Commercial Name	LB 03	LB 06	LB 04	Ø 1.4 mm cord	in skylight wing
Dimension (mm)	48,8 x 65,3 x 1,2	30 x 24 x 1	29,7 x 26,5 x 1	used as a brake	
Material	Al	Al	Al		
					
Color	Standard: elox	Extra Charges: RAL 9003 white		white	

Plastic components in the RAL 7040 color, RAL 9003.

Due to the development of the product, it is possible to adapt the product.

Standard dimensions

Width (mm)		Height (mm)		Guaranteed area (m ²)
min.	max.	min.	max.	max.
300	1200	300	1450	1,7

We do not make atypical designs.

R-Lite (2-00100-0000)

Position	Item name	Abbreviation	Drawing number
10	Head rail	LB 03	7-300657-PU52
10	Bottom rail	LB 06	7-300661-PU52
10	Side guide channel	LB 04	7-300658-PU52
10	Bottom rail extension profile	LR 23	7-300804-PU52
10	Tube	RR 15/1	7-300245-0000
10	Sealing profile	RHD 20	6-001298-0000
10	Plastic tape 6mm	RHD 09	6-001294-0000
10	Spring left l=600/1	LR 26/1	7-301204-00001
10	Spring left l=600/1,3	LR 26/2	7-301254-0000
10	Tilt rod - triangular	IS 14	7-300050-0000
10	Adhesive tape, double	RR 21	6-001310-0000
200	Board R + L	LR 51	2-00389-7040
300	Roller-blind pin - right	LR 17	3-00609-0000
310	Roller-blind pin - left	LR 18	3-00610-0000
400	Screw	LR 102	3-01203-0000
500	Bottom rail cover R + L	LB 52	2-00387-7040
600	Case	LR 14	3-00650-0000
700, 701	Side guide pad	LB 19/1	3-01425-7040
700, 701	Side guide pad - universal	LB 19	3-00603-0000
800	Side guide channel cover R+L	LB 53	2-00386-7040
900	Spring pin	LR 13	3-00608-0000
910	Shring tubing, black Ø19/Ø9,5	LR 15	6-010997-0002
1000	Clip	LB 20/2	3-01424-7040
1000	Clip	LB 20/3	3-02693-0000
1010	Pad 100°	LB 32/3 100	3-02693-0000
114	Pad 102°	LB 32/3 102	3-02697-0000
1010	Pad 105°	LB 32/3 105	3-02698-0000
1010	Pad 90°	LB 32/3 090	3-02694-0000
1010	Pad 96°	LB 32/3 096	3-01238-0000
1011	Pad 2 mm	LB 32/1	3-01436-0000
1012	Pad 3 mm	LB 32/2	3-01437-0000
1100	Plastic pin - body	LR 21	3-00620-0000
1200	Plastic pin - cartridge	LR 22	3-00621-0000
1300	Assembly template	LB 21/1	3-01426-7040
1404-1416	Screw 3x20 Zn	RR 22	6-001312-0000
1500	Screw KB 22x10	LB 28	6-000054-0000
1600	Screw 3,5x13 Zn	A 67/8	6-003146-0000
1700	Fabric		see Fabric sampler
1800	Cord 1,4	A 34	6-000153-5000
1900	Clamping screw	A 70/2	2-00399-0000
2000	Control rod	LB 50	2-00377-xxxx
2010	Telescopic rod - with hook	LB 200	2-00420-0001
2010	Telescopic rod - with hook and joint	LB 250	2-00420-0002
2100	Tightener	LB 56	2-00102-0000

R-Lite Skylight Roller Blinds

Measurement and Assembly Manual

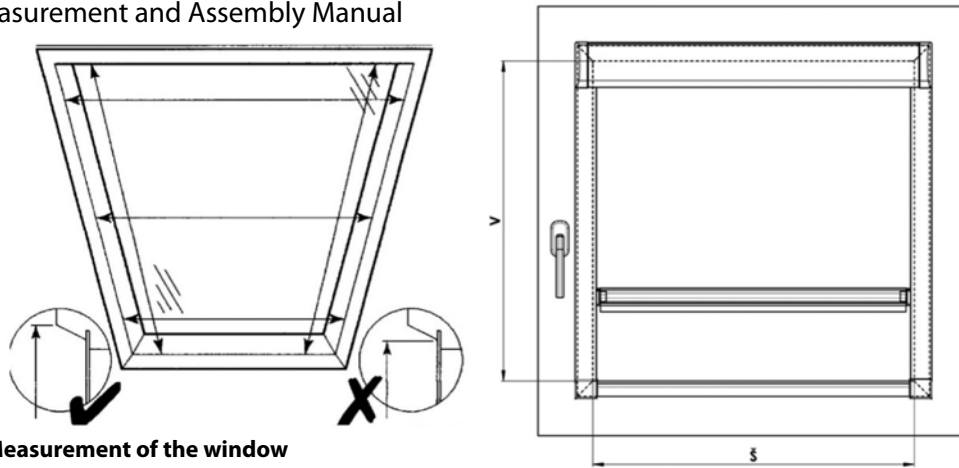

1. Measurement of the window

Take the measurements as indicated in the picture. Measurements are taken at the top of the frame of the window wing, not at the glazed area. If the window has a model label, then it is sufficient to mention in the order form the exact name and model of the roof window. The minimum depth for assembly is 40 mm.

THE WIDTH AND HEIGHT OF THE LIGHT HOLE IN THE WINDOW WING IS MEASURED IN THE FOLLOWING WAY:

Š.... (width)

The measurement is from the left top to the right top of the window wing, up in the place of the roller blind fixation. The width of the blind is produced in a precision of millimeters from the width 300 mm up to the width of 1200 mm.

It is recommended to consult with the manufacturer dimensions outside the stated limits.

V (height)

Measurements are taken in the same way as width, from the upper top to the lower top of the window wing and these are written into the order form of the blind.

The height of the blind is produced with a precision of millimeters from the height 300 mm up to the height 1600 mm.

It is recommended to consult with the manufacturer dimensions outside the stated limits, too.

IN THE ORDER FORM, IT IS NECESSARY TO SPECIFY:

1. dimension
2. type of window and identification number of the window
3. angle of the glazing bar (90°, 96°, 100°, 102°, 105°)

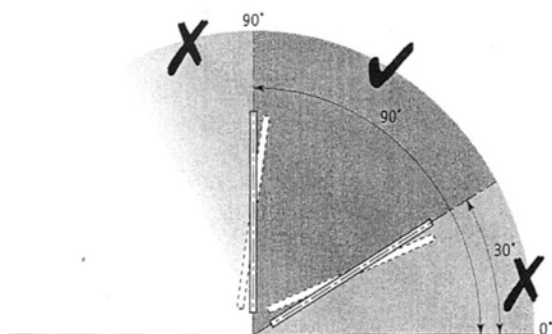

ATTENTION!

If the sky light window does not have a model label and there is no possibility to state the angle of the glazing bar, it is necessary to mention in the order form, in addition to the dimensions on the top of the frame, the dimensions for the glass, including the depth of the window frame. The exact angle of the glazing bar of the frame of the roof window can be derived from these parameters.

ATTENTION!!! THE ANGLE OF THE ROOFDECLINATION MUST NOT BE LESS THAN 30° AND MORE THAN 90°.

2. ASSEMBLY

Assemble exactly according to this manual to prevent redundant assembly errors and other related problems.

AIDS FOR ASSEMBLY:

- electric drill
- cross-head screwdriver
- knife, scissors, pliers
- allen key 1,5
- for clip fixation: screw 3x17

CONTROL:

- before assembly we recommend to inspect all of the delivered parts of the goods to prevent any problems. The manufacturer must be notified of any defects or comments concerning the assembly of the blinds.
- never unfold the roller blind before assembly.
- remove all obstacles from the sky light that could prevent the assembly.

ASSEMBLY

- never expand the blind before assembly
- remove all obstacles from the sky light that could prevent the assembly.

FIXATION OF CEILING CLIPS:

- place the angle clip to the upper edge of the window wing in the distance which delimit the clip end stop itself (see picture one).
- screw and then break off the exceeding parts, which defined the assembly depth (for plastic window use fore drilled holes – drill ϕ 2mm).



FIXATION OF THE UPPER PROFILE:

- loose the stretching cords on the roller blind .
- assembly bases of the clip must be pressed to the side boards of the roller blind (see picture two).
- catch the upper profile and slip it frontally on the angle ceiling clips to make the end stop click (see picture three).



GUIDING CHANNELS ASSEMBLY:

- insert the guiding channels under the upper profile, align them with the edge of the frame and screw them.
- pay attention that the stretching cords are not between the guiding channels and the window frame.



FIXATION OF THE STRETCHING CORDS:

- clamp the stretching holders located on the ends of cords into the lower ends of the guiding channels.

ADJUSTMENT OF THE ROLLER BLIND BRAKE:

- if necessary, the brake of the blind can be adjusted by setting the stretching cords - both of them must be stretched in the same level!!
- adjust the brake by moving the metal roller on the end of the cord. The following rule is always valid: the higher the stretching of the cord, the higher braking of the blind.
- the correctly adjusted brake holds the blind in any position when lifting.
- ATTENTION! - Too much stretching of the leading cords can damage the whole roller blind breaking system.
- cut off the excess cord ends.



COMPLETION:

- lower the blind by catching the lower bar into the lower part of the window and check the functionality.
- the blind is ready for good use.



R-Lite Skylight Roller Blinds

Measurement and Assembly Manual

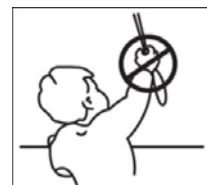

The roller blind is installed in agreement
with safety elements of the norm
EN 13120

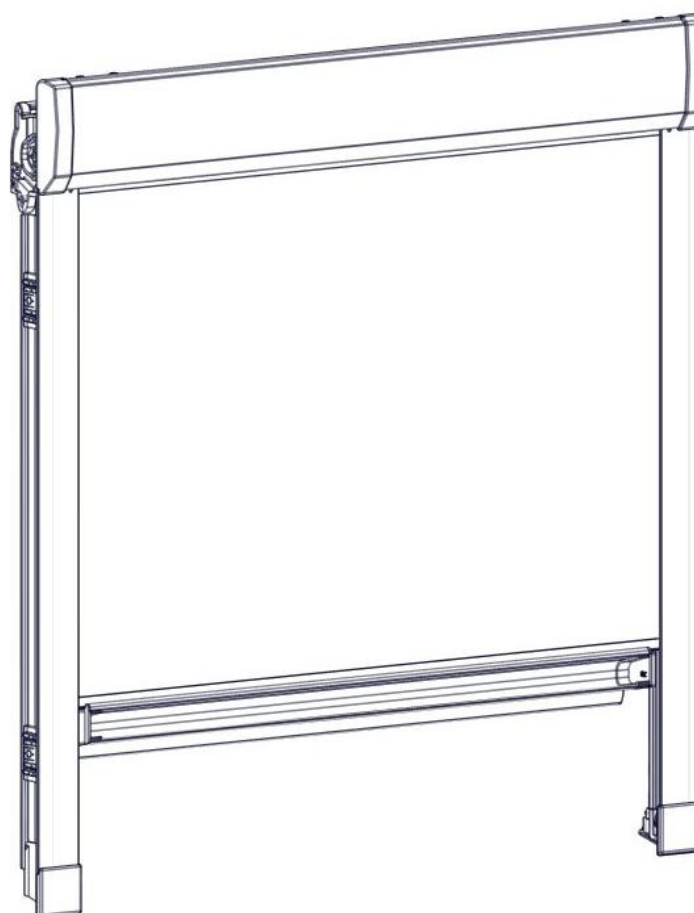
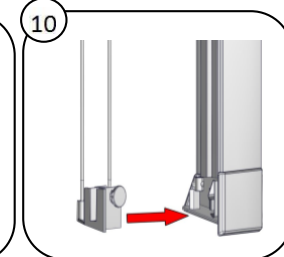
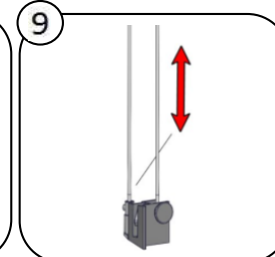
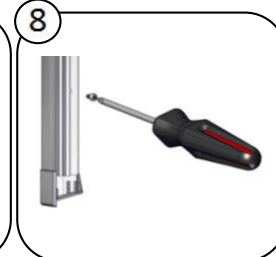
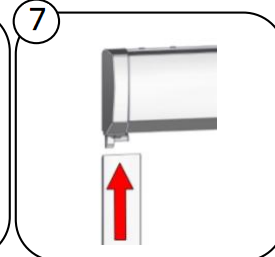
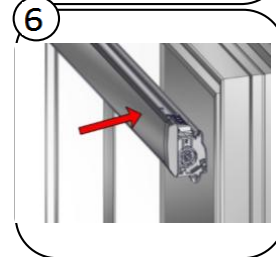
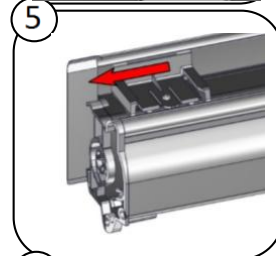
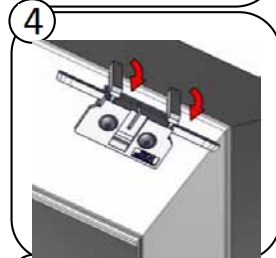
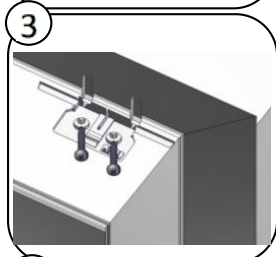
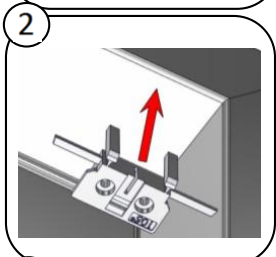

Safety features according to the standards EN 13120+A1; EN 16 433; EN 16 434



Connection



Pulley



Winch



Two wheels

[illegible]