

A close-up photograph of a wooden window frame with a black insect screen handle. The handle is a sleek, rectangular, black plastic piece mounted on the wooden frame. The wood has a warm, reddish-brown finish with visible grain. The insect screen is a fine, light-colored mesh visible in the background.

Labona®

## Insect screens

Technical data sheet



## Table of Contents – Insect Screens

<b>Insect Screen C1</b>	<b>3</b>	<b>Insect Screen G10</b>	<b>33</b>
BasicProduct Specification	4-5	BasicProduct Specification	34-35
Measuring	6	Measuring	36
Installation	6	Installation	37 - 38
<b>Insect Screen C2</b>	<b>7</b>	<b>Insect Screen H1</b>	<b>39</b>
BasicProduct Specification	8-9	BasicProduct Specification	40-41
Measuring	10	Measuring	42
Installation	10	Installation	43
<b>Insect Screen C10</b>	<b>11</b>	<b>Pleated insect screen PS1,PS1V</b>	<b>45</b>
BasicProduct Specification	12-13	BasicProduct Specification	46
Measuring	14	Measuring	47
Installation	14	Assemblyinto reveal	48-50
<b>Insect Screen C11</b>	<b>15</b>	<b>Pleated insect screen PS2,PS2V</b>	<b>51</b>
BasicProduct Specification	16-17	BasicProduct Specification	52
Measuring	18	Profiles	53
Installation	18	Assemblyinto reveal	54-55
<b>Insect Screen C20</b>	<b>19</b>	<b>Pleated insect screen PS3V</b>	<b>57</b>
BasicProduct Specification	20-21	BasicProduct Specification	58
Measuring	22	Profiles	59
Installation	22	Assemblyinto reveal	60-62
<b>Insect Screen E</b>	<b>23</b>	<b>Pleated insect screen PS4V</b>	<b>63</b>
BasicProduct Specification	24-25	BasicProduct Specification	64
Measuring	26	Profiles	65
Installation	26	Assemblyinto reveal	66-68
<b>Insect Screen F10</b>	<b>27</b>	<b>Pleated insect screen PS1,PS1V,PS2,PS2V,PS3V,PS4V</b>	
BasicProduct Specification	28-29	Measurement	69
Measuring	30	Assemblyon the frame	70-71
Installation	31 - 32		

## ISOTRA *Quality*

A brand symbolizing yearsof tradition, innumerable investments into researchand development, use of high-quality materials, technological advancement, reliable work of hundreds of employeesand many more parameters,which together form one whole-the final product of the company ISOTRA.



# Insect Screen C1



- ▲ 31 x 12 mm aluminum frame
- ▲ installation does not require any interventions in window frame
- ▲ suitable for windows without shutters
- ▲ frame color design according to RAL scheme, wood imitation or single-sided renolit-coating

**ISOTRA** *Quality*



## Insect screen c 1

### Basic Product Specification

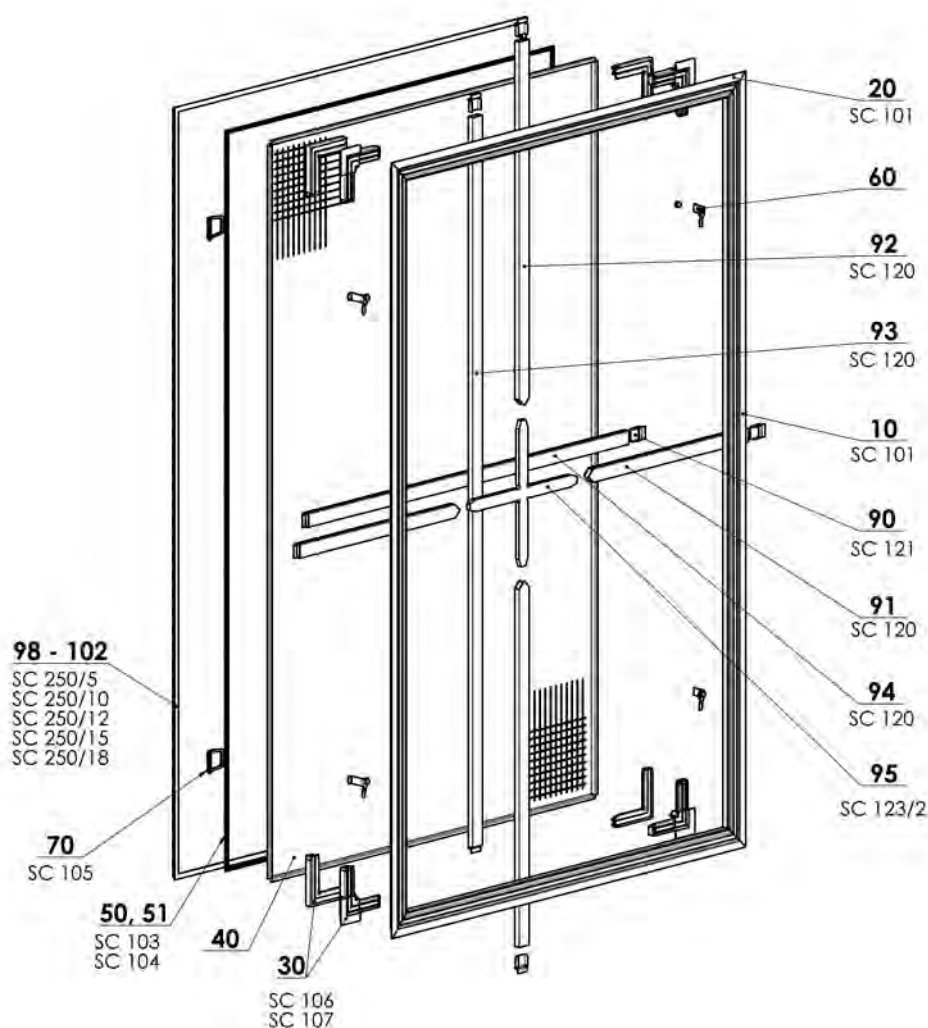

2-00304-XXXX-C

### specification

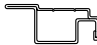
	Frame	Maximum Guaranteed Dimensions	Attach- ment Method	Installation clips	clip / Pin / swivel / Box Holder size (mm)	Flange		Mesh			
						Inner	Outer	Grey	Black	thick	White
<b>commercial name</b> <b>Dimension (mm)</b> <b>Material</b>	SC101 31 x 12 Al 	3,6 m <sup>2</sup> max. h. 2000 mm max. w. 2000 mm	rotary clip	4/6*	15, 17, 18, 20, 22, 24, 26, 28, 30, 32	yes	yes	yes	yes	yes	yes

#### color

Standard:  
RAL9003 White (double-sided)  
RAL8019 Brown (double-sided)  
RAL7016 anthracite gray (double-sided)

Extra change:  
other RAL (double-sided)  
wood imitation (double-sided)  
renolit (single-sided)

We make atypical designs. Atypical mesh is always fitted with reinforcement and inner flanges.

\* 6 clips fitted above the height of 1401 mm. The clips are always arranged evenly along the vertical screen sides (if it is not specified differently).

Rotary clip kit contains: 1 right clip, 1 left clip, 2 rivets.

Aluminum reinforcement is mounted in the case of width/height exceeding 1200 mm.

It is invalid for the white mesh that one of the measures (width or height) have to be smaller than 1450 mm.

For reinforced netting, one of the dimensions (width or height) must be less than 1150 mm.

For black and gray netting, one of the dimensions (width or height) must be less than 1750 mm.

## Insect screen c1 (2-00304-0000)

Position	name of components	Abbreviation	number of tech. drawing
10-20	Profile Al - C1	SC101	6-001421-xxxx
30	Angle, plastic C1 external	SC106	6-001424-xxxx
30	Angle, plastic C1 internal	SC107	3-00330-0000
<b>40</b>	<b>Insect screen</b>		
50-51	Locking rubber 6,50mm - transparent	SC104	6-001381-0000
50-51	Locking rubber 5,75mm - transparent	SC103	6-001328-0000
<b>60</b>	<b>Bracket Insect A</b>		<b>viz. Profile bracket Insect A</b>
70	Insert handle - transparent	SC105	6-001360-0000
90	Window partition holder	SC121	6-001349-xxxx
91-94	Profile Al 19x7	SC120	6-001318-xxxx
95	Cross reinforcement	SC123/2	3-02928-0000
98-99	Brush 6,7x500 S	SC250/5	6-001314-0500
101	Brush 6,7x1000 EC	SC250/10	6-001314-1000
102	Brush 6,7x1200 EC	SC250/12	6-001314-1200
102	Brush 6,7x1500 EC	SC250/15	6-001314-1500
102	Brush 6,7x1800 EC	SC250/18	6-001314-1800

## Profile bracket Insect A – position 60

## Profile bracket Insect A c1

name of components	Abbreviation	Dimension A (mm)
Profile bracket, metal	SC111	15
Profile bracket, metal	SC112	17
Profile bracket, metal	SC113	18
Profile bracket, metal	SC114	20
Profile bracket, metal	SC115	22
Profile bracket, metal	SC124	24
Profile bracket, metal	SC125	26
Profile bracket, metal	SC126	28
Profile bracket, metal	SC127	30
Profile bracket, metal	SC128	32

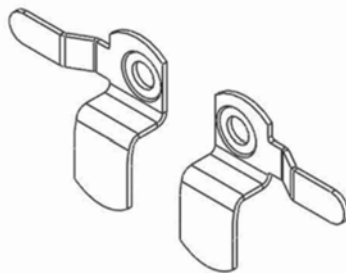

## Insect screen c 1

### Measuring

Measure the clearance width and height of the aperture in which the screen is to be installed in. Window frame depth for the screen fitting = clip height. Conduct measuring in three points, state the lowest value.

In order to determine the screen dimensions and window frame (clip) depth as precisely as possible, we recommend using the specific screen sample frame (C1).

The screen frame profile width for the C1 type is 31 mm including the collar. Profile size is 31 x 12 mm.

The screen frame extends to the frame clearance 22 mm from the window frame edge.

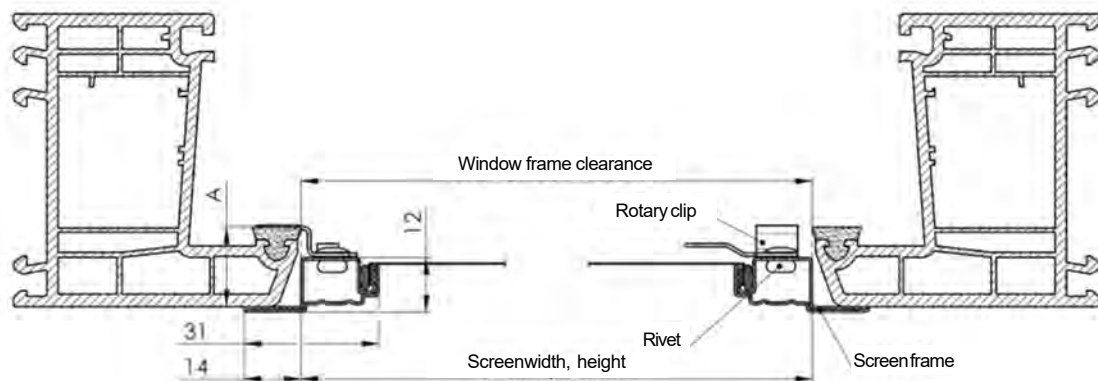

### Installation

Installation is carried out from the interior using rotary clips and does not require any drilling or other window frame invasion. Fix the screen in the frame by turning the clips. The rotary clips are riveted to the frame and their height is given by the frame depth of the window, where the screen is installed.

#### **Important !!**

The screen is not suitable for windows with shutters or other obstacle that would prevent the screen recessing.

#### Selection of rotary clips

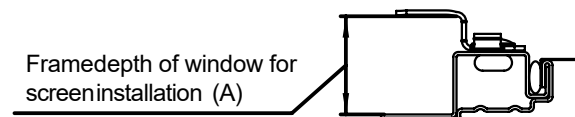

In the case of screen size exceeding 1200 mm, we recommend adding a reinforcement. This recommendation applies to both the screen length and width.



## Insect Screen C2



- ▲ 31 x 11 mm round aluminum frame
- ▲ installation does not require any interventions in window frame
- ▲ suitable for windows without shutters
- ▲ frame color design according to RAL scheme, wood imitation or double-sided renolit coating

**ISOTRA** *Quality*



## Insect screen c 2

### Basic Product Specification

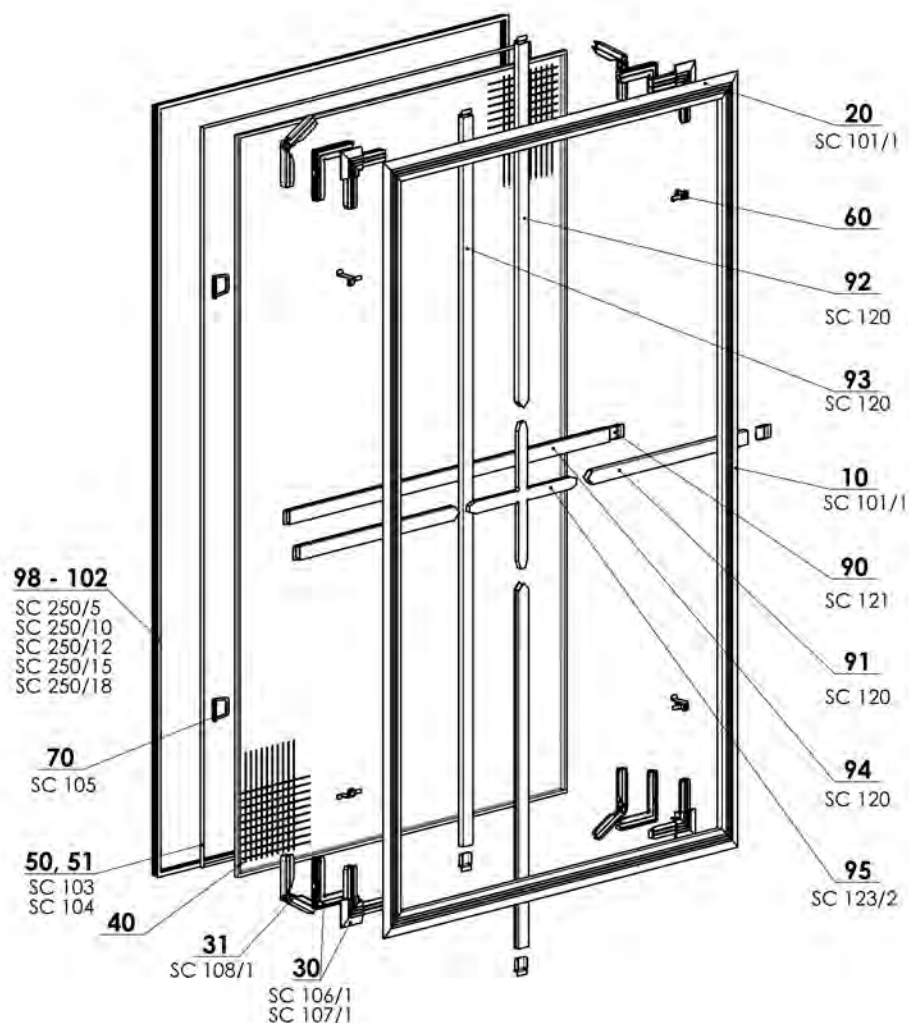

2-00357-0000-D

### specification

	Frame	Maximum Guaranteed Dimensions	Attach- ment Method	Installation c lips	clip / Pin / swivel / Box Holder size (mm)	Flange		Mesh			
						Inner	Outer	Grey	Black	thick	White
<b>commercial name</b> <b>Dimension (mm)</b> <b>Material</b>	SC101 / 1 31 x 11 Al	3,6 m <sup>2</sup> max. h. 2000 mm max. w. 2000 mm	rotary clip	4/6*	15, 17, 18, 20, 22, 24, 26, 28	yes	yes	yes	yes	yes	yes

#### color

Standard:  
RAL9003 White (double-sided)  
RAL8019 Brown (double-sided)  
RAL7016 anthracite gray (double-sided)

Extra change:  
other RAL (double-sided)  
wood imitation (single-sided/double-sided)  
renolit (single-sided/double-sided) according to the current sampler  
Isotra Systém Decorall end II. according to the current sampler

We make atypical designs. Atypical mesh is always fitted with reinforcement and inner flanges.

\* 6 clips fitted above the height of 1401 mm. The clips are always arranged evenly along the vertical screen sides (if it is not specified differently).

Rotary clip kit contains: 1 right clip, 1 left clip, 2 rivets.

Aluminum reinforcement is mounted in the case of width/height exceeding 1200 mm.

It is invalid for the white mesh that one of the measures (width or height) have to be smaller than 1450 mm.

For reinforced netting, one of the dimensions (width or height) must be less than 1150 mm.

For black and gray netting, one of the dimensions (width or height) must be less than 1750 mm.



**Insect screen c2 (2-00357-0000)**

Position	name of components	Abbreviation	number of tech. drawing
10-20	Profile Al - C2	SC101/1	3-01175-xxxx
30	Angle, plastic C2internal	SC107/1	3-01243-0000
30	Angle, plastic C2external	SC106/1	2-00378-xxxx
<b>40</b>	<b>Insect screen</b>		
50	Locking rubber 5,75mm - transparent	SC103	6-001328-0000
51	Locking rubber 6,50mm - transparent	SC104	6-001381-0000
<b>60</b>	<b>Bracket Insect A</b>		<b>viz. Profile bracket Insect A</b>
70	Insert handle - transparent	SC105	6-001360-0000
90	Window partition holder	SC121	6-001349-xxxx
91-94	Profile Al 19x7	SC120	6-001318-xxxx
95	Crossreinforcement	SC123/2	3-02928-0000
98-99	Brush 6,7x500 S	SC250/5	6-001314-0500
101	Brush 6,7x1000 EC	SC250/10	6-001314-1000
102	Brush 6,7x1200 EC	SC250/12	6-001314-1200
103	Brush 6,7x1500 EC	SC250/15	6-001314-1500
104	Brush 6,7x1800 EC	SC250/18	6-001314-1800

**Profile bracket Insect A – Position 60****Profile bracket Insect A c2**

name of components	Abbreviation	Dimension A [mm]
Profile bracket, metal	SC112	13
Profile bracket, metal	SC113	15
Profile bracket, metal	SC114	17
Profile bracket, metal	SC115	18
Profile bracket, metal	SC124	20
Profile bracket, metal	SC125	22
Profile bracket, metal	SC126	24
Profile bracket, metal	SC127	26
Profile bracket, metal	SC128	28
Profile bracket, metal	SC127	30
Profile bracket, metal	SC128	32

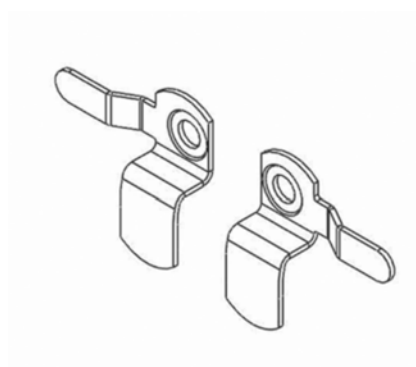

## Insect screen c 2

### Measuring

Measure the clearance width and height of the aperture in which the screen is to be installed in. Window frame depth for the screen fitting = clip height. Conduct measuring in three points, state the lowest value.

In order to determine the screen dimensions and window frame (clip) depth as precisely as possible, we recommend using the specific screen sample frame (C2).

The screen frame profile width for the C2 type is 31 mm including the collar. Profile size is 31 x 11 mm.

The screen frame extends to the frame clearance 20 mm from the window frame edge.

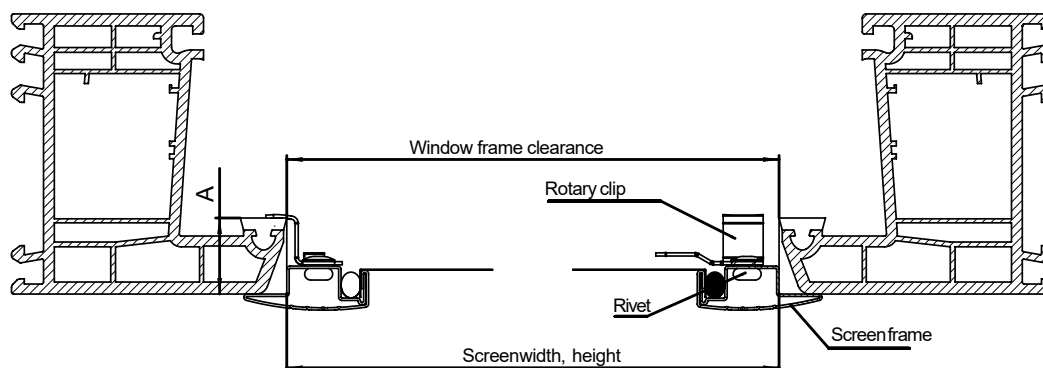

### Installation

Installation is carried out from the interior using rotary clips and does not require any drilling or other window frame invasion. Fix the screen in the frame by turning the clips. The rotary clips are riveted to the frame and their height is given by the frame depth of the window, where the screen is installed.

#### **Important !!**

The screen is not suitable for windows with shutters or other obstacle that would prevent the screen recessing.

#### Selection of rotary clips

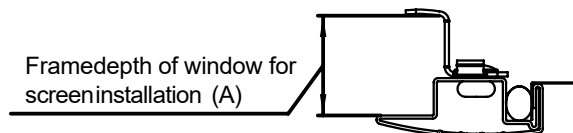

In the case of screen size exceeding 1200 mm, we recommend adding a reinforcement. This recommendation applies to both the screen length and width.



## Insect Screen F10



- ▲ optional horizontal pulling up and down of screen
- ▲ 50 x 42mm extruded aluminum box
- ▲ installation in reveal or on window frame requires drilling in window frame
- ▲ suitable for double-wing windows or balcony doors
- ▲ frame color design according to RAL scheme

**ISOTRA** *Quality*

## Insect screen F10

### BasicProduct Specification

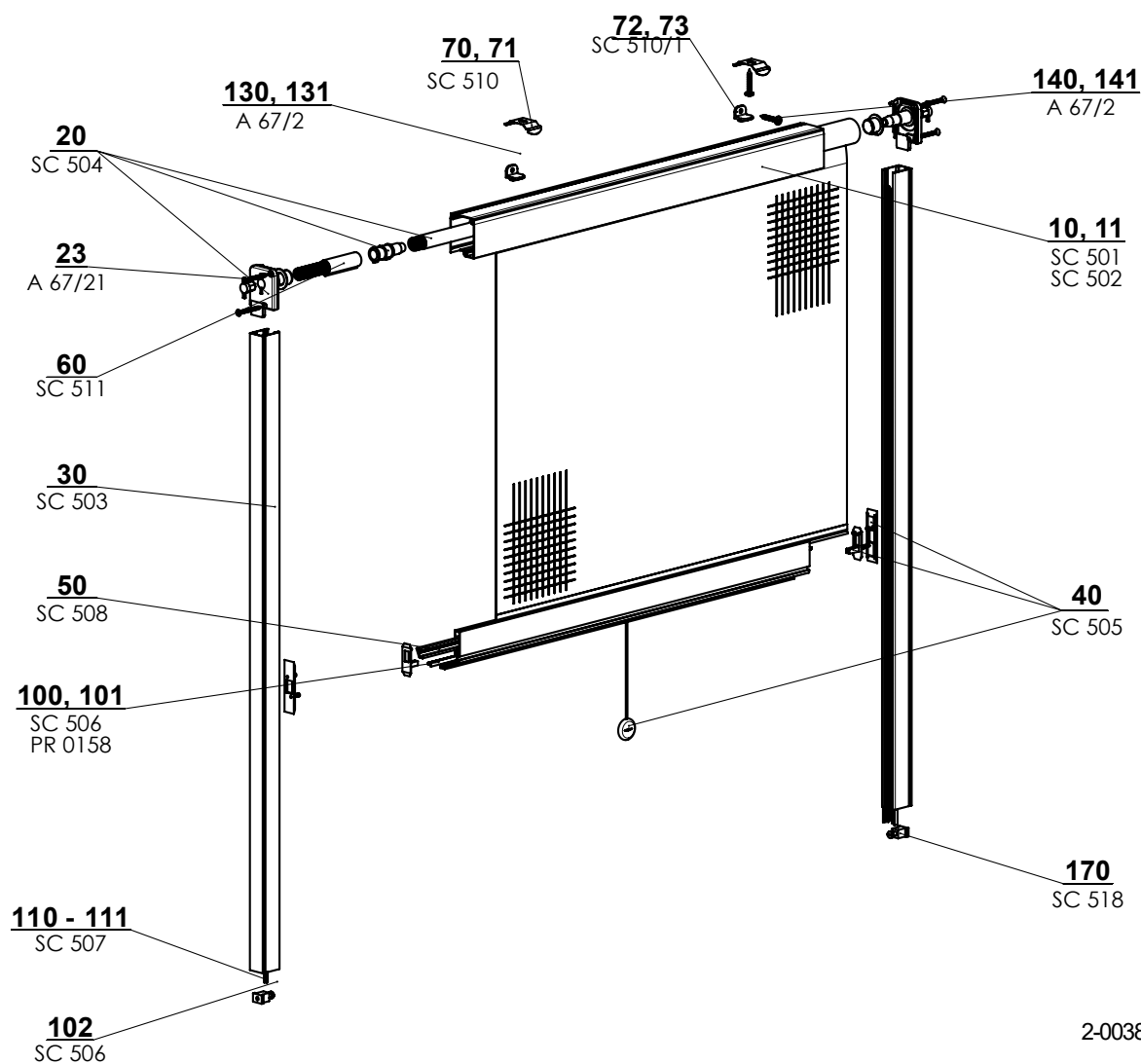

2-00381-XXXX-B

### specification

	Frame	Maximum Guaranteed Dimensions	Attachment Method	Installation clips	Flange		Mesh			
					Inner	Outer	Grey	Black	thick	White
<b>commercial name</b> <b>Dimension (mm)</b> <b>Material</b>	SC504 horiz. box 50 x 42 Al 	3.6 m2 max. height 2400 mm max. width 1700 mm	box holderson frame / in reveal	Basedon dimensions	no	no	yes	no	no	no
<b>color</b>	Standard: RAL9003 White (double-sided) RAL8019 Brown (double-sided)				Extra change: other RAL(double-sided)					

We do not make atypical designs.



**Insect screen F10 (2-00381-0000)**

<b>position</b>	<b>name of components</b>	<b>Abbreviation</b>	<b>number of tech. drawing</b>
10	Alu rod with mesh 1.75 m (incl. installation box and end rail)	SC501	6-004430-xxxx
11	Alu rod with mesh 2.4 m (incl. installation box and end rail)	SC502	6-004429-xxxx
20	Set of components – box	SC504	6-004453-xxxx
23	Screw 3.9×16, DIN 7982 C, Zn, countersunk, Phillips	A 67/21	6-009450-0000
30	Guide rail 22 Al 30×22 mm	SC503	6-004432-xxxx
40	Set of components for central lock	SC505	6-004311-xxxx
50	Drawbar 1.3 m	SC508	6-004310-xxxx
60	Brake	SC511	6-004314-0000
70-71	Upper box holder for window installation	SC510	6-004309-xxxx
72-73	Upper box holder for frame installation, PVC	SC510/1	6-016310-xxxx
100-102	Brush 4.8×10 mm – GREY	SC506	6-004315-0001
100	Brush for SL-I4.8×20 mm	PR0158	6-001749-0000
110-111	Brush AW4.8×10 mm	SC507	6-004316-0000
130-131	Screw 4×25 Zn, round-head, Phillips	A 67/2	6-002289-0000
140-141	Screw 4×25 Zn, round-head, Phillips	A 67/2	6-002289-0000
170	End rail stop piece	SC518	6-004454-0000

## Insect screen F10

### Measuring

- In case of attachment to the jamb as well as the frame, it is necessary to measure the screen manufacture dimensions according to the location layout
- when measuring, remember that there must be the minimum required space for the holder (clip) of 16 mm above the screen box
- measure the screen at least in three points in width and height and state the lowest measured value
- these measured values are manufacturing dimensions to be stated in the order form
- the form must state whether the customer wishes the scrolling screen to contain the winding brake, as well; this is suitable for lower height screens, the winding of which is more rapid than - higher screens.

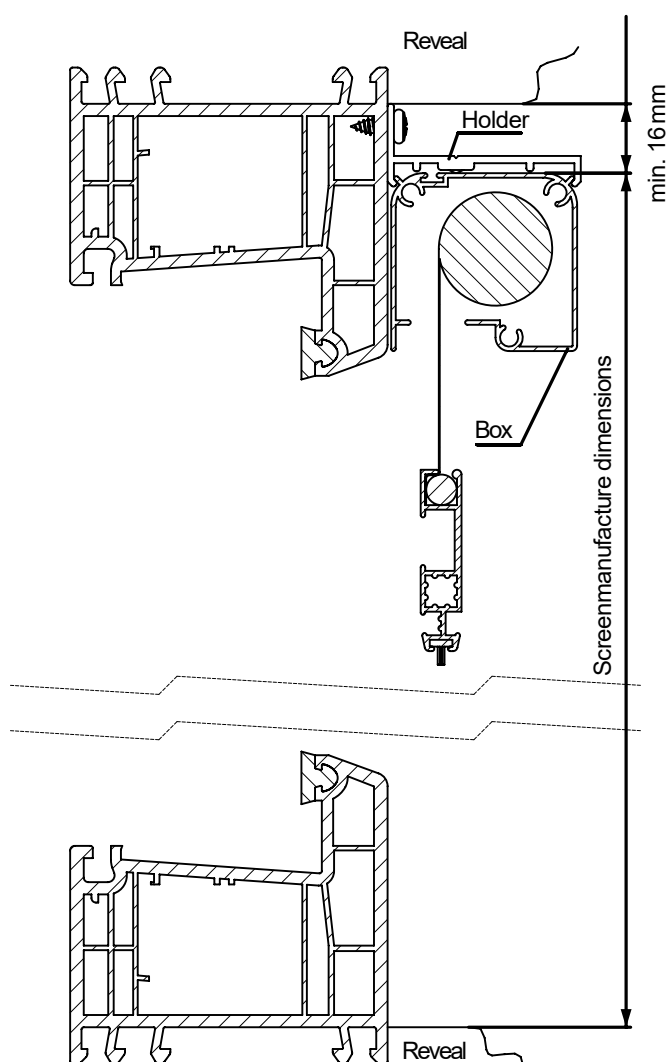
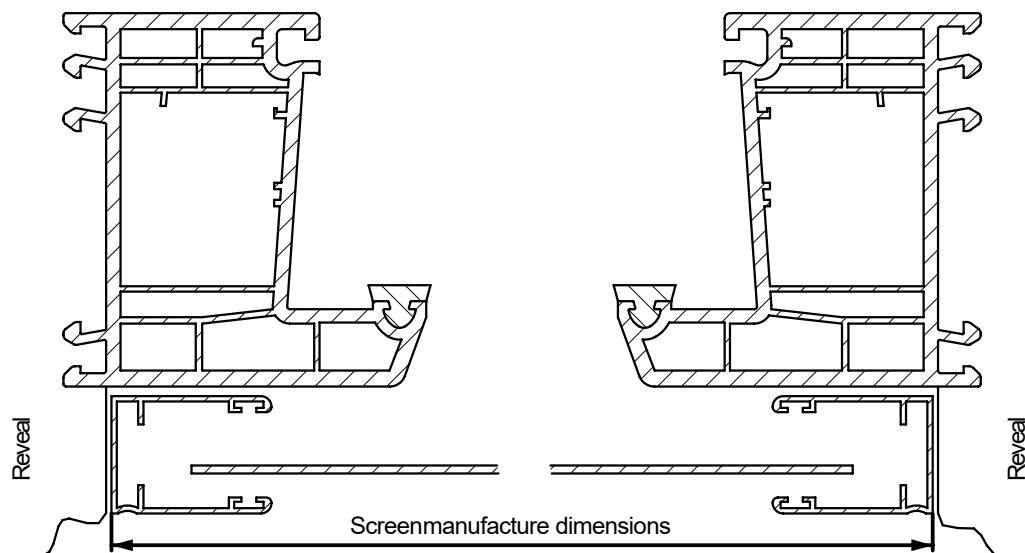



## Insect screen F10

### Installation

#### scrolling screen Installation in reveal

- take the SC510 holder, identify the holes to be drilled
- screw the holders (clips) on after drilling
- put the brush on the box in the upper slot, required for sealing the space between holders and box
- put the box in the holders and snap it on
- pre-drill holes in the guiding rails using the  $\varnothing 4$  mm drill bit and recess them!!! Without recessing, the screw head would inhibit the locking wand track!!! The rail is not factory-predrilled!
- identify the drilled part, like on the box
- place the prepared guide rails to the box sideboard pins
- make sure the screen with the end rail is properly slipped in the guiding rail; make sure the end rail ending does not get into the locking stop slot; it would be impossible to pull the screen down
- make sure the AW brush (fixed bevelled) in the guiding rail is always by the window frame; it is to prevent the screen getting out of the guiding rail, such as in draught
- screw the guiding rails to reveal
- pull down the screen and adjust the locking stops, fitted in the guiding rails, as required; the stop has 4 Allen screws
- pull the screen up and down for several times to align the screen in the box after transportation
- test locking and tightness of the end rail to the parapet or other ending

#### Warning

The figure has the end rail turned differently from reality. View from exterior.

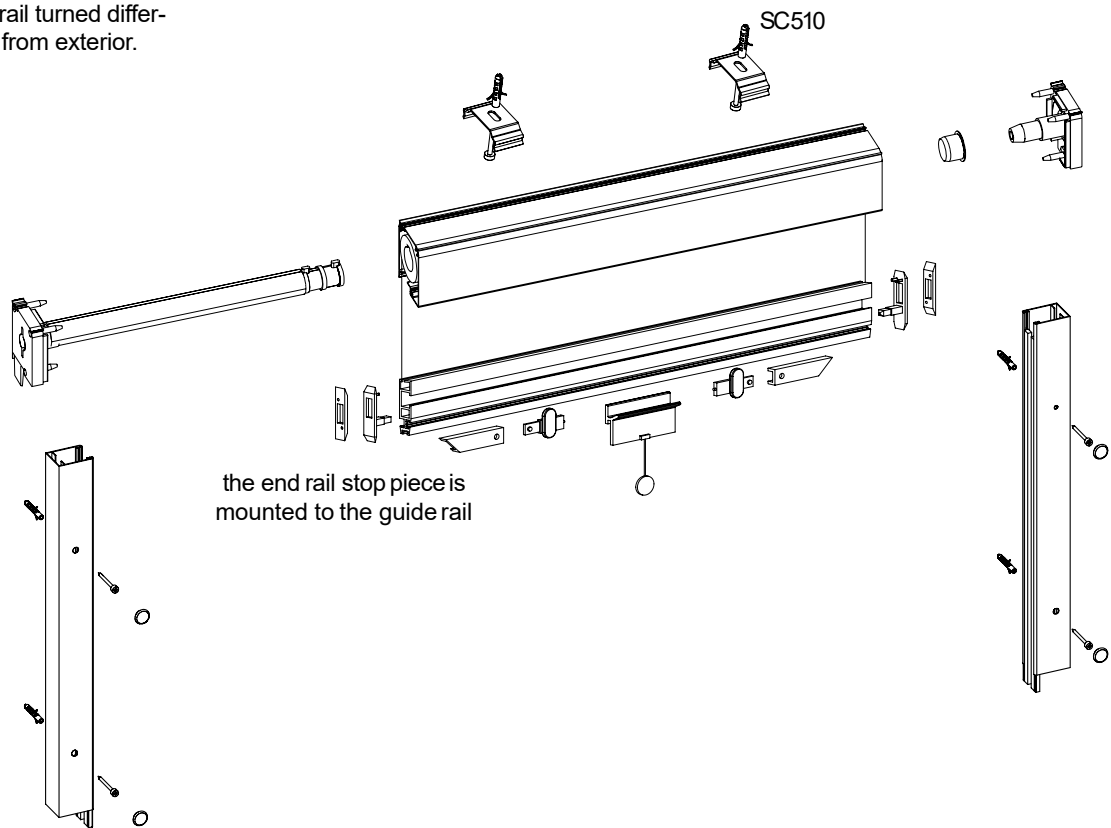

## Insect screen F10

### Installation

#### scrolling screen Installation on Window Frame

- take the SC509 holders, place them to the assembly position on the box and lock them using an Allen head screw
- attach the box to the frame and identify holes for fixing the box
- pre-drill holes in the guiding rails using the  $\varnothing 4$  mm drill bit through the guiding rail
- use the  $\varnothing 10$  mm drill bit for the Installation aperture cover
- place the prepared guide rails to the box sideboard pins
- make sure the screen with the end rail is properly slipped in the guiding rail; make sure the end rail ending does not get into the locking stop slot; it would become impossible to pull the screen down
- make sure the AW brush (fixed bevelled) in the guiding rail is always by the window frame; it is to prevent the screen to get out of the guiding rail, such as in draught
- attach such assembled screen to the frame and screw the holders with the box to the window frame
- screw the guiding rails to the frame using recessed screws
- put the installation aperture cover in the aperture
- pull the screen down and adjust the locking stops in the guiding rails as required; the stop has 4 Allen screws
- pull the screen up and down for several times to align the screen in the box after transportation
- test locking and tightness of the end rail to the parapet or other ending
- put the end rail stops in the guiding rail as required; this mainly applies to those applications, which are not terminated with parapet or other ending.

#### Warning

The figure has the end rail turned differently from reality. View from exterior.

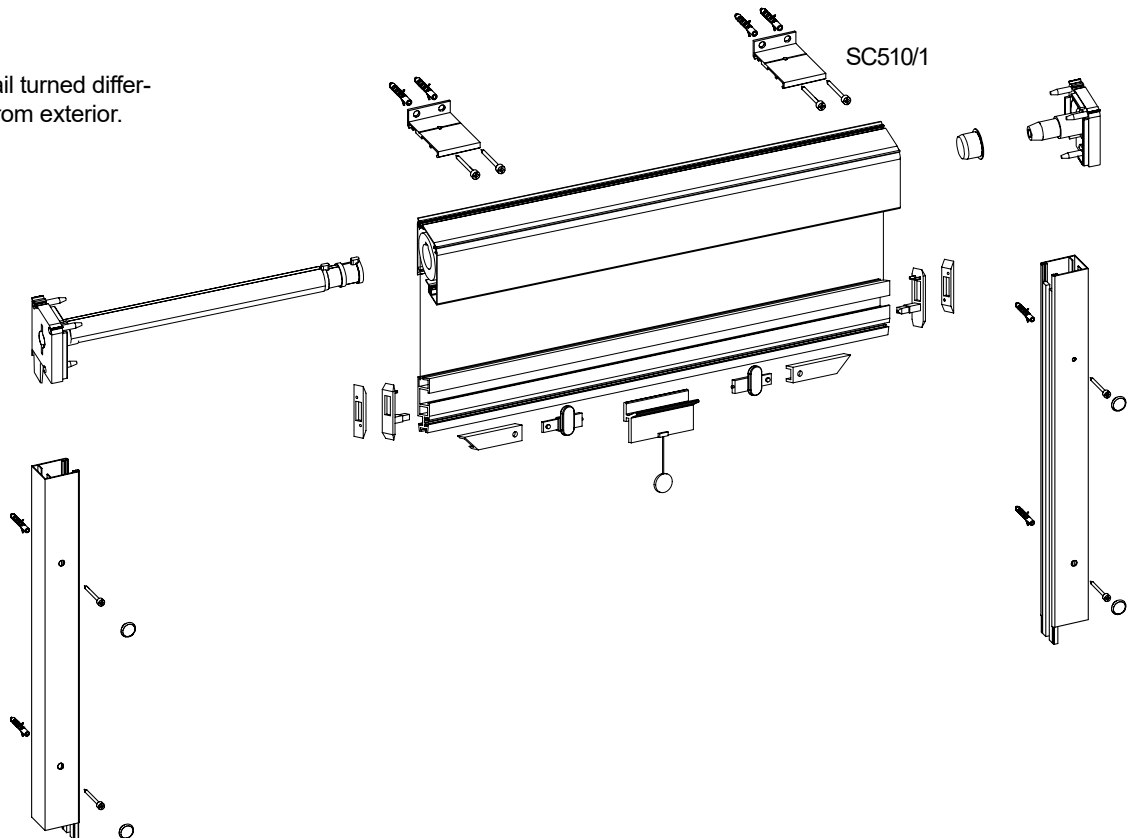

#### enclosed components including fastening material

- holder for fixing the box in reveal
- holder for fixing the box onto the window frame
- installation aperture cover (for installation on window frame)
- end rail stop (for installation on window frame)
- 4x40 mm screw (for installation in reveal)
- 4x20 mm screw (for installation of guiding rails on window frame)
- 4x16 mm screw (for installation of holders on window frame)

#### tools for measuring and installation

- tape meter
- pencil
- cross-head screwdriver
- $\varnothing 4$  mm and  $\varnothing 10$  mm drill bits
- drilling machine
- spirit level



## Insect Screen G10



- ▲ optional vertical pulling up and down of screen
- ▲ 50 x 42 mm extruded aluminum box
- ▲ installation in reveal or on window frame requires drilling in window frame
- ▲ suitable for double-wing windows or balcony doors
- ▲ frame color design according to RAL scheme

**ISOTRA** *Quality*

## Insect screen G10

### BasicProduct Specification

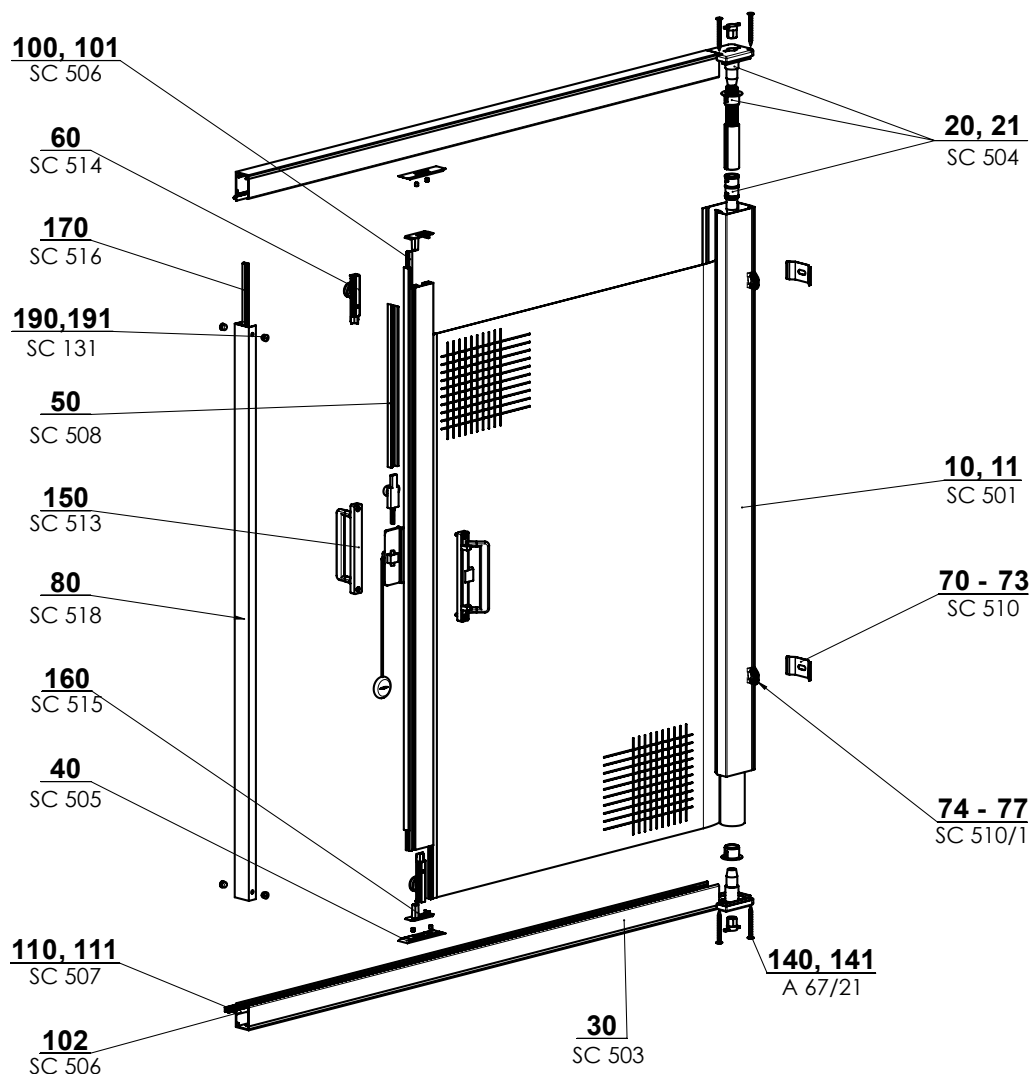

2-00382-XXXX-C

### specification

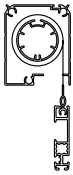
	Frame	Maximum Guaranteed Dimensions	Attachment Method	Installation clips	Flange		Mesh			
					Inner	Outer	Grey	Black	thick	White
<b>commercial name</b> <b>Dimension (mm)</b> <b>Material</b>	SC504 vert. box 50 x 42 Al 	3.6 m2 max. height 2500 mm max. width 1400 mm	box holderson frame / in reveal	Basedon dimen- sions	no	no	yes	no	no	no
<b>color</b>	Standard: RAL9003 White (double-sided) RAL8019 Brown (double-sided)				Extra change: other RAL (double-sided)					

We do not make atypical designs.

## screen G10 (2-00382-0000)

position	name of components	Abbreviation	number of tech. drawing
10, 11	Alu rod with mesh 1.75 m (incl. installation box and end rail)	SC501	6-004430-xxxx
20, 21	Set of components – box	SC504	6-004453-9010
30	Guide rail 22 Al 30×22 mm	SC503	6-004311-xxxx
40	Set of components for central lock	SC505	6-004311-xxxx
50	Drawbar 1.3 m	SC508	6-004310-xxxx
60	Guide wheel – black	SC514	6-004464-9004
70-73	Upper box holder for window installation (white/black)	SC510	6-004309-9010/9004
74-77	Upper box holder for frame installation, PVC(white/black)	SC510/1	6-004451-9010/9004
80	Alu closure section, lowered 22×24 (colourless)	SC518	6-016681-0000
100-102	Brush 4.8×10 mm – grey	SC506	6-004315-0001
110-111	Brush AW4.8×10 mm	SC507	6-004316-0000
140-141	Screw 3.5×13, DIN 7504 O,Zn, countersunk, Phillips	A 67/21	6-003112-0000
150	PVC double-side handle – pair – white/black	SC513	6-004466-9010/9004
160	End rail stop piece – pair – white/black	SC515	6-004465-9010/9004
170	Magnets for the closure section – both poles	SC516	6-004467-0000
190	Blind rivet Al 4×6 DIN 7337 A, white	SC131	6-002678-9010
191	Blind rivet Al 4×6 DIN 7337 A, brown	SC131	6-002678-8014



## Insect screen G10

### Measurement and assembly manual

#### Measurements

##### Simple screen

- the screen is locked in the closed position by a magnetic strip in the end rail and by the closing profile
- when measuring, it is necessary to take into consideration that there must be the required room for the holder (clamp) min. 16mm beside the screen box
- for the type fixed into the reveal and on the frame, a hole is measured into which the screen will be fitted
- the screen is measured as a minimum, at three points for the height and width and the minimum measured value is recorded
- these measured values are manufacturing dimensions that are stated in the order form
- Simple screens are produced in widths of 500mm to 2500mm and up to a height of 2500mm.

##### Double screen

- the screen is locked in the closed position by a magnetic strip in the end rail and by the central lock
- when measuring, it is necessary to take into consideration that there must be the required room for the holder (clamp) min. 16mm beside the screen box
- for the type fixed into the reveal and on the frame, a hole is measured into which the screen will be fitted
- the screen is measured as a minimum, at three points for the height and width and the minimum measured value is recorded
- these measured values are manufacturing dimensions that are stated in the order form and indicated as the "Control centre"
- Double screens are produced in widths of 500mm to 2500mm and up to a height of 2500mm.

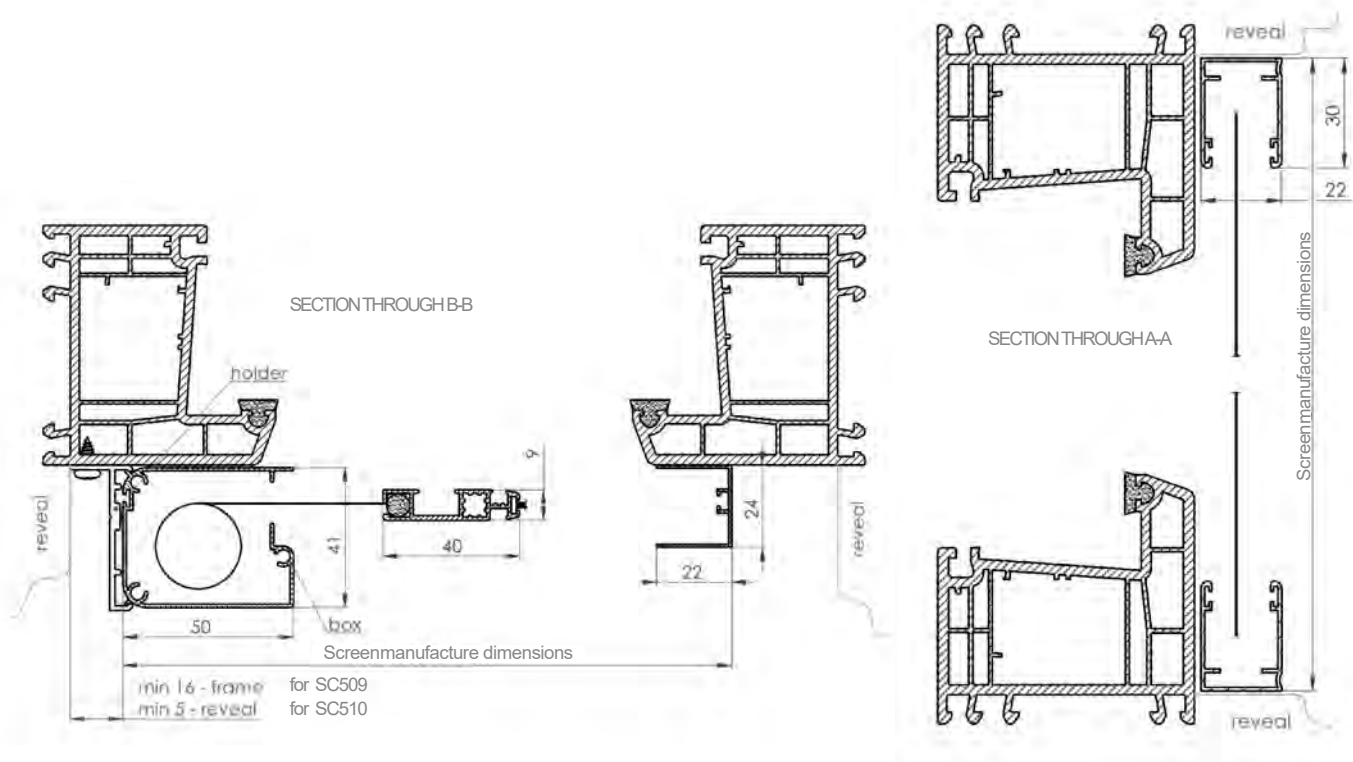

## Insect screen G10

### Measurement and assembly manual

#### Assembly

##### Assembly of simple screen into the reveal

- take holders SC510, mark holes for drilling
- attach the holders (clamps) after drilling
- attach the brush on the box into the upper groove; this is required for sealing the area between the holders and the box
- fit the box into the holders and click it
- drill into the holes on the guide bar using a 4mm diameter drill and deepen the hole. The rail is not factory-predrilled!
- mark the drilled part, the same as the box
- attach the prepared leading bars into the nosing on the side part of the box
- make sure that the screen with the terminal bar is correctly fitted on the guide bar. Pay attention that end of the terminal bar is not located in the groove for the locking arrester!
- ensure that the AW brush (firm, beveled) in the guide bar is always at the window frame. This serves for moving the screen from the guide bar, e.g. during a draught
- on the guide bars fit the closing profile and rivet it with the guide bar. When fitting the closing profile, it is necessary that the magnetic strip in the profile is off-centre. The magnetic strip must be close to the frame.
- use screws to attach the guide rails and the closing profiles to the jamb and door head
- adjust the travel wheels
- move the screen several times in the upward and downward direction to align the screen in the box after the move
- test the fixation

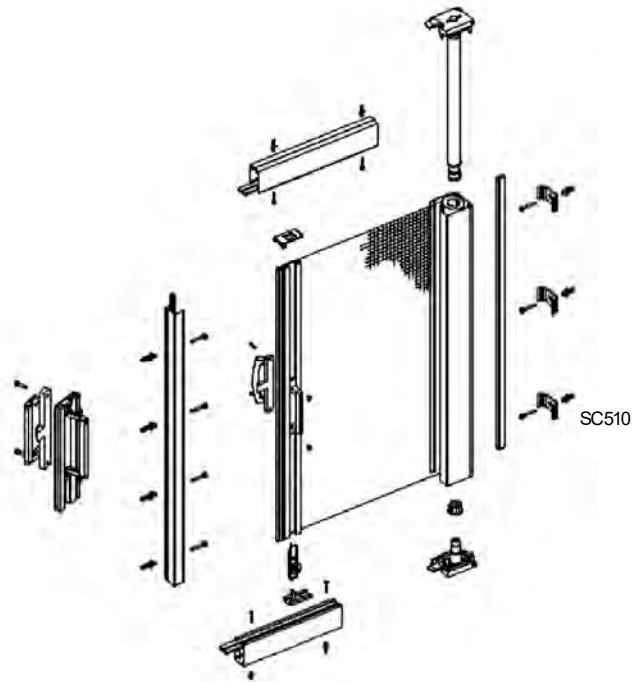

##### Assembly of the simple screen on the window (door) frame

- take the SC509 holders, place them to the assembly position on the box and lock them using an Allen head screw
- place the box on the frame and mark the holes for fixing the box
- drill into the guide bars and the closing profile holes with a 4mm diameter drill and a 10mm diameter drill for the cover of the assembly hole, only on the facing wall! The rail is not factory-predrilled!
- mark the drilled part, the same as the box
- place the prepared guide rails to the box sideboard pins
- make sure that the screen with the terminal bar is correctly fitted on the guide bar. Pay attention that the end of the terminal bar is not located in the groove for the locking arrester!
- ensure that the AW brush (firm, beveled) in the guide bar is always at the window frame. This serves for moving the screen from the guide bar, e.g. during a draught
- on the guide bars, fit the closing profile and rivet it with the guide bar. When fitting the closing profile, it is necessary to make certain that the magnetic strip in the profile is off-centre. The magnetic strip must be close to the frame.
- screw the guide bars and the closing profile I on the window (door) frame
- adjust the travel wheels
- move the screen several times in the upward and downward direction to align the screen in the box after the move
- test the fixation

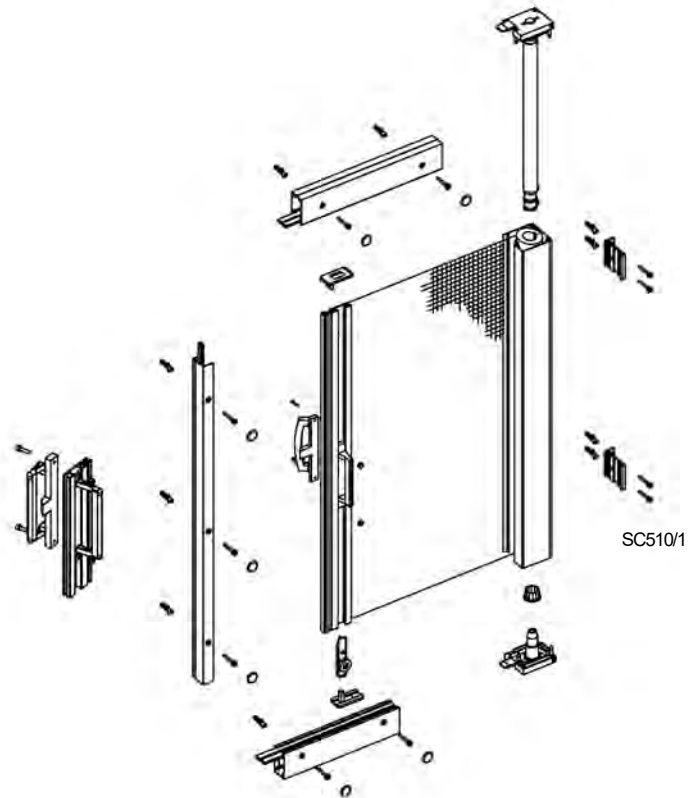

## Insect screen G10

### Measurement and assembly manual

#### Assembly of the double screen into the reveal or on the window (door) frame

- The assembly of the double screen into the reveal or on the window (door) frame is the same as for the assembly of simple screens. The difference is that the double screen has two boxes and instead of the lifting profile there is a central lock as in the case of roll screen F10. The screen is secured with the magnetic strip in both terminal guides.

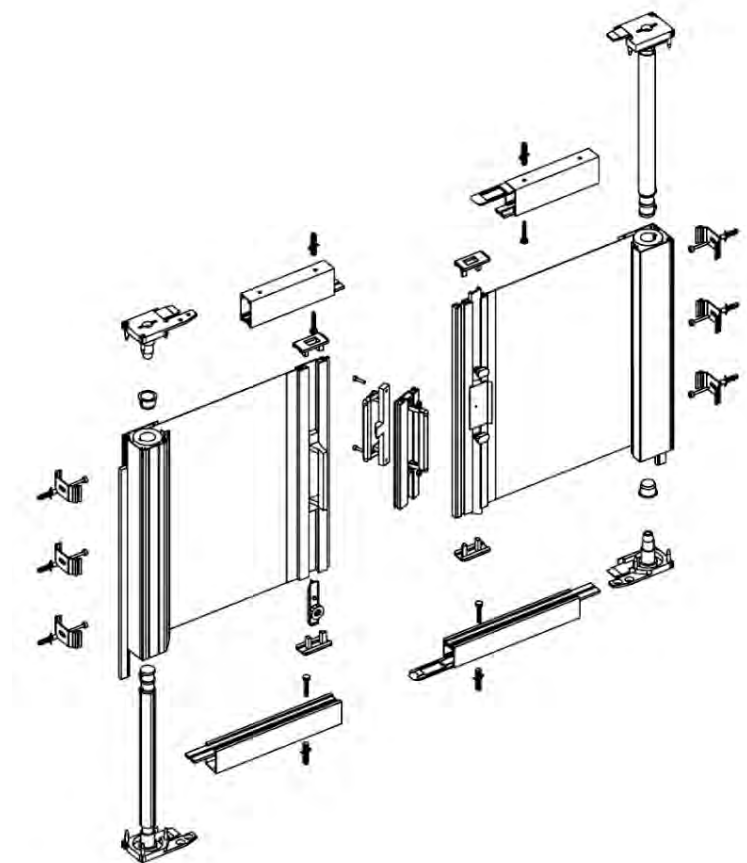

#### At tAcHeD cOMPOnents, IncLuDI nG Anc HOr In G MAT er IAL

- holder for fixing the box into the reveal
- holder for fixing the box on the window frame, cover of the assembly hole (for assembly on the window frame)
- screw 4x40mm (for assembly into the reveal)
- screw 4x20mm (for the assembly of guide bars on the window frame)
- screw 4x16mm (for the assembly of holders on the window frame)
- cutting rivet 4x6mm (for riveting the closing profile and guide bar)

#### tOOLs FO r MeAsur eMent AnD AsseMBLY

- metre rule
- pencil
- cross-head screwdriver
- drills, diameter 4mm and diameter 10mm
- electric drill
- riveting pliers
- spirit level



# Insect Screen H1

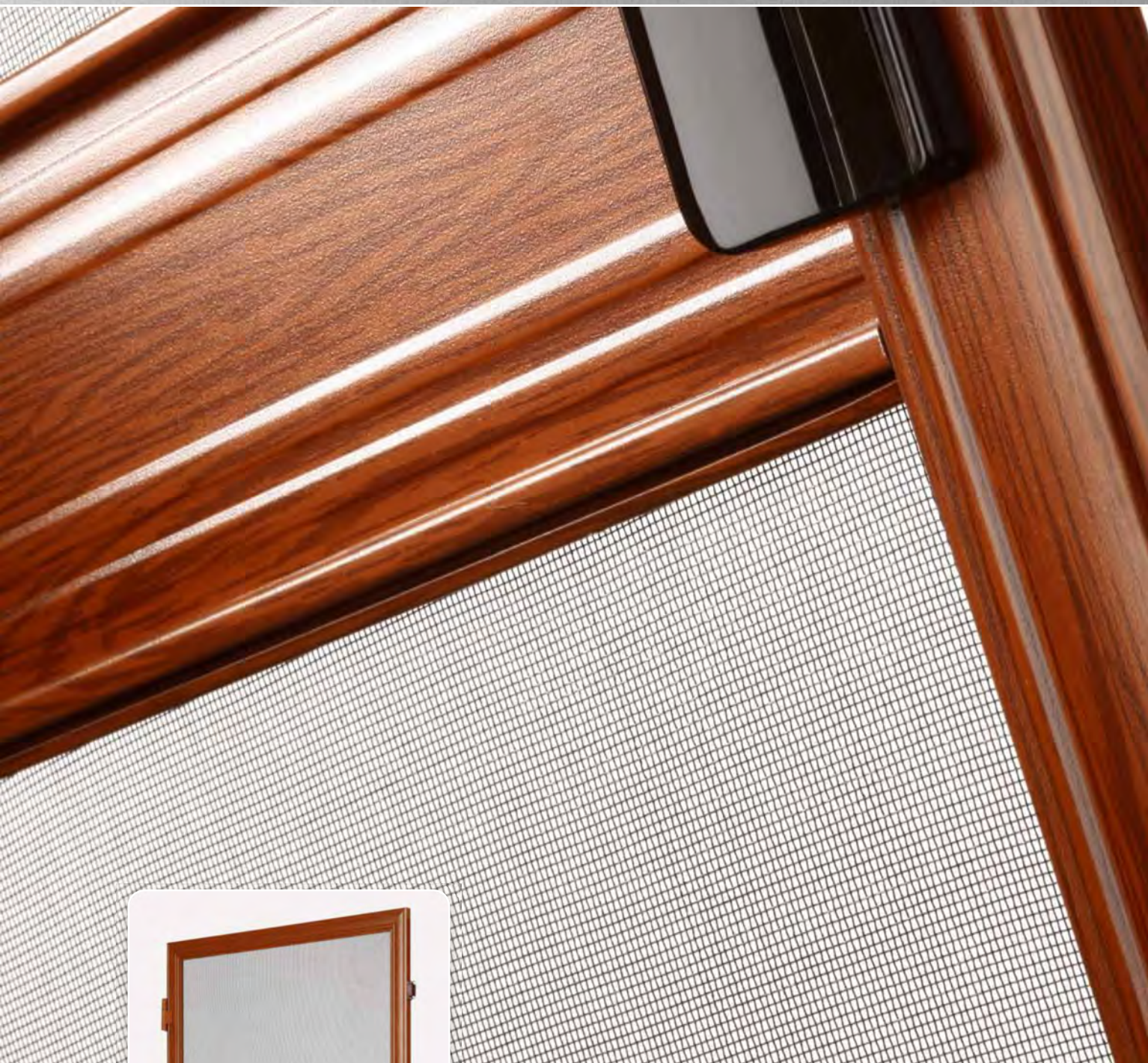

- ▲ 51 x 20 mm rolled aluminum frame
- ▲ higher frame rigidity
- ▲ easy to remove from window or balcony door
- ▲ frame color design according to RAL scheme, wood imitation or double-sided renolit-coating

**ISOTRA** *Quality*



## Insect screen H1

### Basic Product Specification

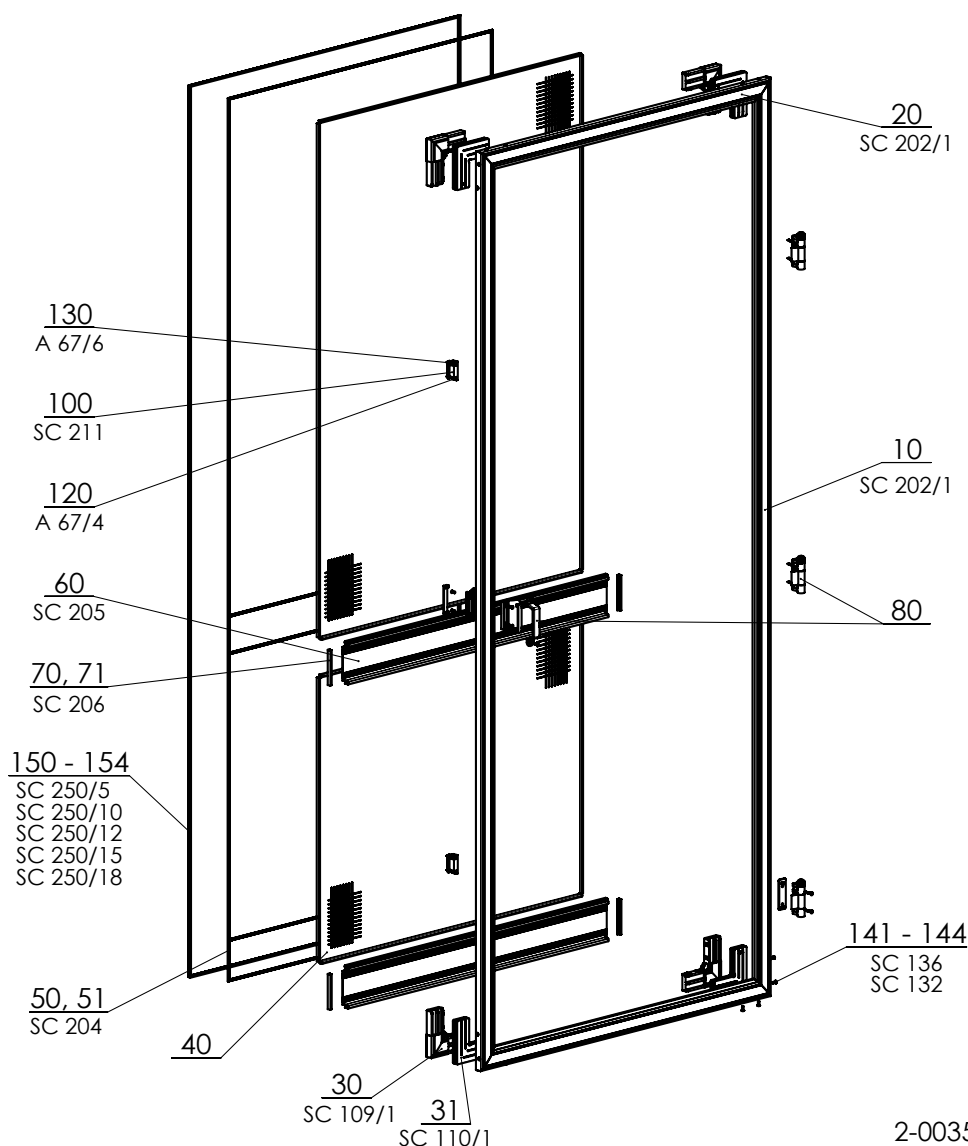

2-00358-XXXX-C

### specification

	Frame	Maximum Guaranteed Dimensions	Attachment Method	Installation clips	Flange		Mesh			
					Inner	Outer	Grey	Black	thick	White
<b>commercial name</b> <b>Dimension (mm)</b> <b>Material</b>	SC202 / 1 51 x 20 Al 	3 m <sup>2</sup> max. height 2400 mm max. width 1500 mm	self-closing hinges	3	yes	yes	yes	yes	yes	yes

#### color

Standard:  
 RAL9003 White (double-sided)  
 RAL8019 Brown (double-sided)  
 RAL7016 anthracite gray (double-sided)

Extra change:  
 other RAL (double-sided)  
 wood imitation (double-sided)  
 renolit (single-sided/double-sided) according to the current sampler  
 Isotra Système Decoral I. and II. according to the current sampler

We do not make atypical designs.  
 The central and foot reinforcements are standard accessories.

It is invalid for the white mesh that one of the measures (width or height) have to be smaller than 1450 mm.  
 For reinforced netting, one of the dimensions (width or height) must be less than 1150 mm.  
 For black and gray netting, one of the dimensions (width or height) must be less than 1750 mm.

**Insect screen H1 (2-00358-0000)**

Position	name of components	Abbreviation	number of tech. drawing
10-20	Profile Al 52x20 H1	SC202/1	3-01176-xxxx
30	Angle, plastic H1 external	SC109/1	2-00379-xxxx
31	Angle, plastic H1 internal	SC110/1	2-00393-0000
<b>40</b>	<b>Insect screen</b>		
50-51	Locking rubber 6,00mm - transparent	SC204	6-003094-0000
60	Horizontal reinforcement for door screen	SC205	6-001454-xxxx
70-71	Door bar holder	SC206	6-001457-xxxx
<b>80</b>	<b>Bracket Insect A</b>		<b>viz. Profile bracket Insect A</b>
100	Magnet	SC211	6-001463-9010
120	Screw 3,5x9,5 mm	A 67/4	6-003096-0000
130	Screw 3x10 mm	A 67/6	6-003137-0001
141-143	Rivet 4x10 DIN 7337 A	SC136	6-002680-0000
144	Rivet 4x8 DIN 7337 A	SC132	6-003068-8003
150	Brush 6,7x500 S	SC250/5	6-001314-0500
151	Brush 6,7x1000 EC	SC250/10	6-001314-1000
152	Brush 6,7x1200 EC	SC250/12	6-001314-1200
153	Brush 6,7x1500 EC	SC250/15	6-001314-1500
154	Brush 6,7x1800 EC	SC250/18	6-001314-1800

**Profile bracket Insect A – Position 80****Profile bracket Insect A H1**

Position	name of components	Abbreviation	number of tech. drawing
4000, 4001	Exterior Al handle	SC209	2-00555-XXXX-B
4002	Plastic handle	SC210	2-00555-XXXX-B
4003	Self-closing hinge L	SC208/2	2-00555-XXXX-B
4003	Self-closing hinge R	SC209/2	2-00555-XXXX-B
4013, 4016	Hinge washer	SC212/1	2-00555-XXXX-B
4502, 4504	Rivet 4x6	SC131	2-00555-XXXX-B
4506	Rivet 4x10	SC136	2-00555-XXXX-B
4508	Screw 4x30	A 67/3	2-00555-XXXX-B

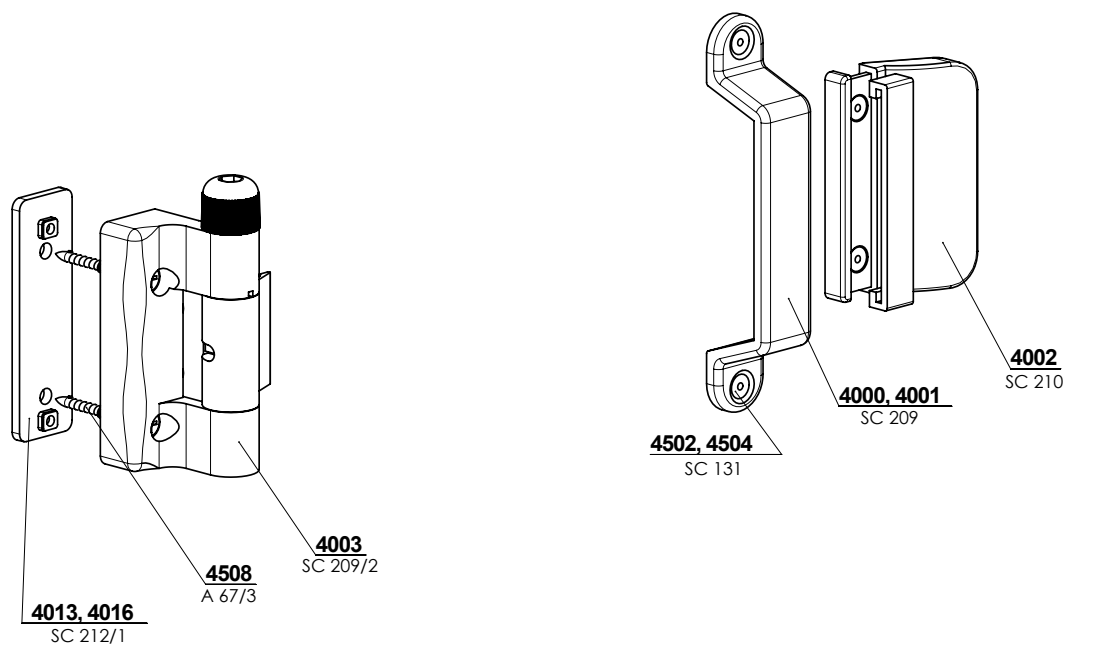

2-00555-XXXX



## Insect screen H1

### Measuring

Always measure the outer screen dimensions – dimension required for manufacture. Remember that there must be space required for the hinges and magnetic locks available next to the screen frame.

Space for hinges = 25 mm

Space for magnet = 15 mm

Space for removal = 15 mm of height

The central partition position is optional. Partition width is 110 mm.

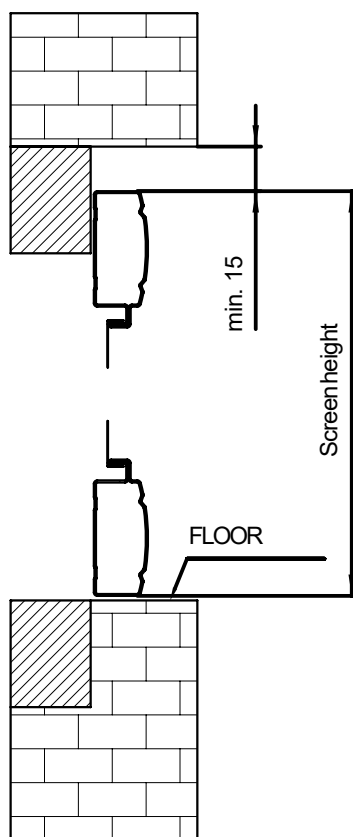
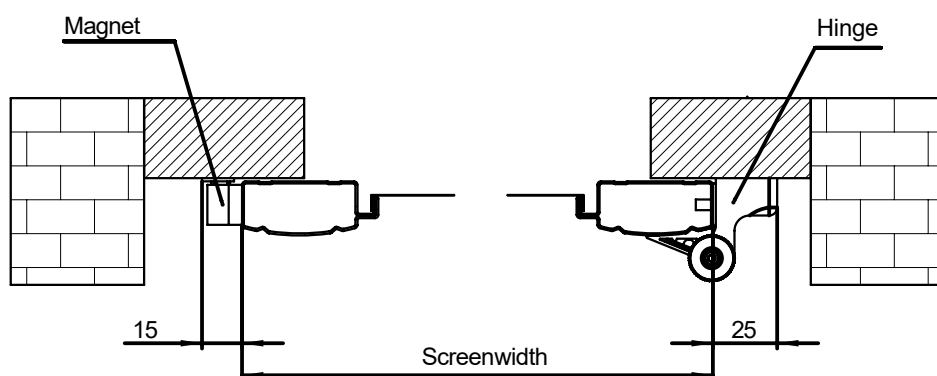

## Insect screen H1

### Installation

The screen is to be mounted by screwing the screen hinges on. Attach the screen with hinges to the frame, identify points for hinge screws (you can pre-drill the apertures for hinge screws) and tighten them.

Standard door screen delivery includes:

- 3 door hinges, 2 magnetic locks, 1 handle
- 4x25 screws for hinges, 3x10 screws for magnet, TEX3.5x13 screw for magnet, tearing rivets for handles.

We supply 3 hinges and 2 magnets for screen size exceeding 2000 x 800 mm. The hinges are pre-stressed in the factory. If you require higher pre-stress, push the hinge pin out, rotate the hexagon using the 6 mm Allen wrench clockwise and push the upper part of hinge back to the hexagon.

Figure 1

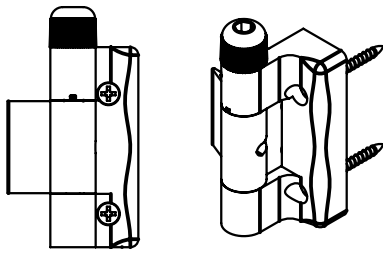
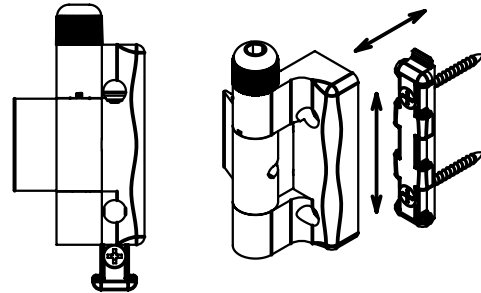
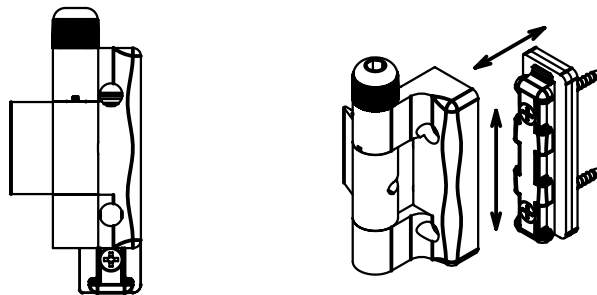

Figure 2



Assembled Hinges

Figure 3



When using brushes on the door screen, washers need to be used under the hinges. The number of washers is to be determined based on the brush size.

This door screen can be dismounted (dismounted without a need to disassemble it) even with the hinges (Figure 2).

### Installation tools:

- tape meter
- pencil
- screwdriver (powered)
- drill bit with diameter of 2 mm
- drilling machine
- tearing riveting machine
- 6 mm Allen wrench





## Pleated insect screen PS1,PS1V



- ▲ Vertical
- ▲ 4 mm lower profile
- ▲ Assembly into reveal and on the frame
- ▲ Modern design

**ISOTRA** *Quality*

## Pleated Insect screen Ps 1, Ps 1 V

### Basic Product Specification

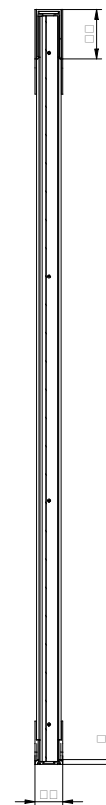
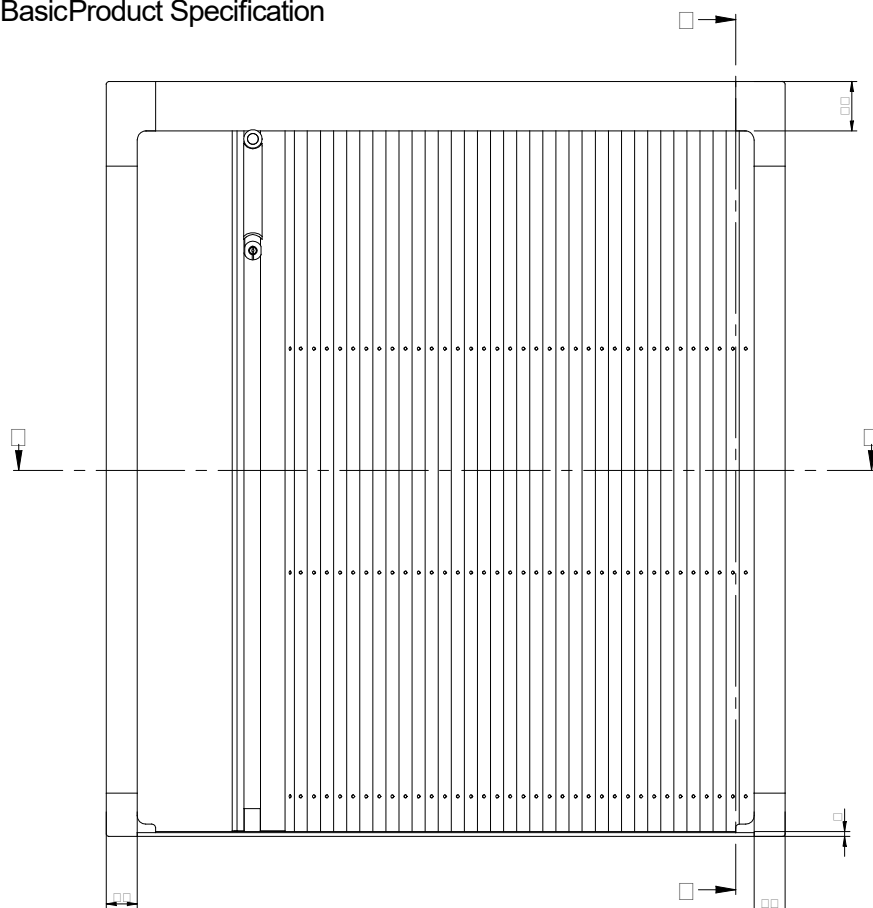

SECTION □□□□

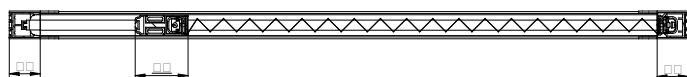

SECTION □□□□

2-01293-000V (PS1)  
2-01295-100V (PS1V)

### Limit dimensions

	Min. width (mm)	Max. width (mm)	Min. height (mm)	Max. height (mm)
PS1	700	2500	1750	2750
PS1V*	700	2500	800	1700
			2800	3400

\*nonstandard delivery

### standard colours Ps 1

Mesh	Frame	Plastic parts
Grey Black	RAL9010 White RAL1013 Ivory RAL8017 Brown RAL7016 Anthracite RAL6005 Green mat	White Black Brown Ivory

Note: other RAL and DECORAL colours for extra charge

### standard colours Ps 1 V

Mesh	Frame	Plastic parts
Grey Black	RAL9010 White RAL1013 Ivory RAL8017 Brown RAL7016 Anthracite RAL6005 Green mat	White Black Brown Ivory

Note: colour RAL7035 for extra charge

## Pleated insect screen Ps 1, Ps 1 V Profiles

Horizontal section

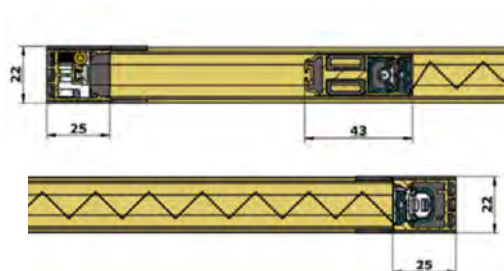

Profiles into reveal

Lower profile 4mm SCPGI(6-013419-0000)

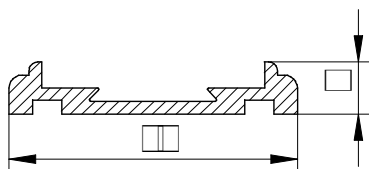

Magnet channel SCPPC(6-013463-0000)

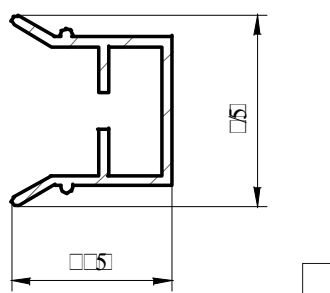

Movable channel SCPBA(6-013418-0000)

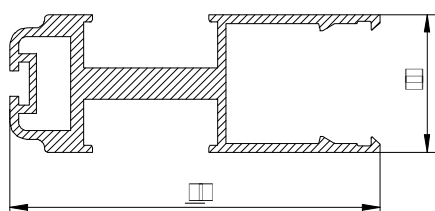

### Profiles on the frame

Profile AL-side channel 40 mm SCPMPT  
(6-013477-0000)

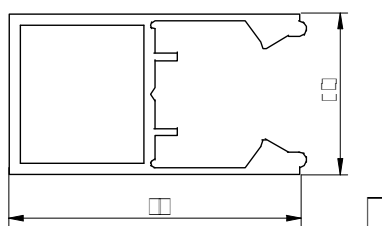

Vertical section

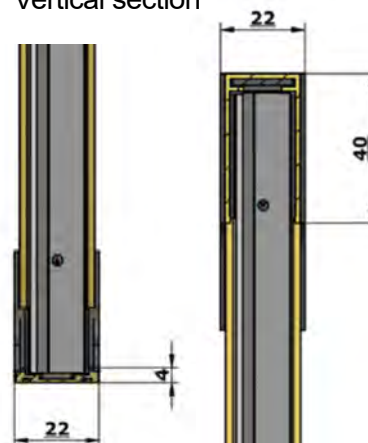

Profile AL-upper channel 40 mm SCPGS(6-013420-0000)

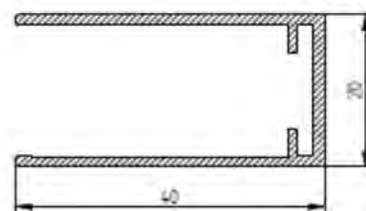

Profile AL-side start channel 25 mm SCPMP(6-013422-0000)

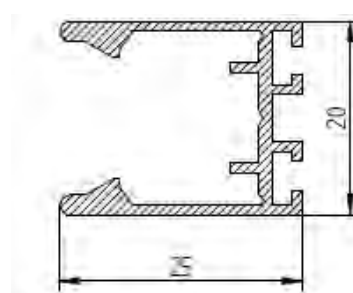

Profile AL-upper channel 40 mm SCPGT  
(6-013462-0000)

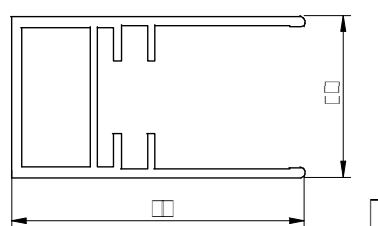



## Pleated Insect screen Ps 1, Ps 1 V

### Assembly into reveal

#### 1. Frame installation

Place the plastic components on the upper and lower profile (see the detail on below picture). Remove the protection of the double sticker and fix the upper and lower profile in the installation place. Correct any differences in length by sliding the angles pieces along. If you want to screw the lower profile, the screws must have a countersunk head!

Decide on which side the opening will be placed. Insert side guiding profile into corner component.

First, in the upper profile and consequently to the lower profile.

Drill holes for fixing profiles (these holes should correspond with the holes in the vertical profiles). Fix it using the enclosed screws.

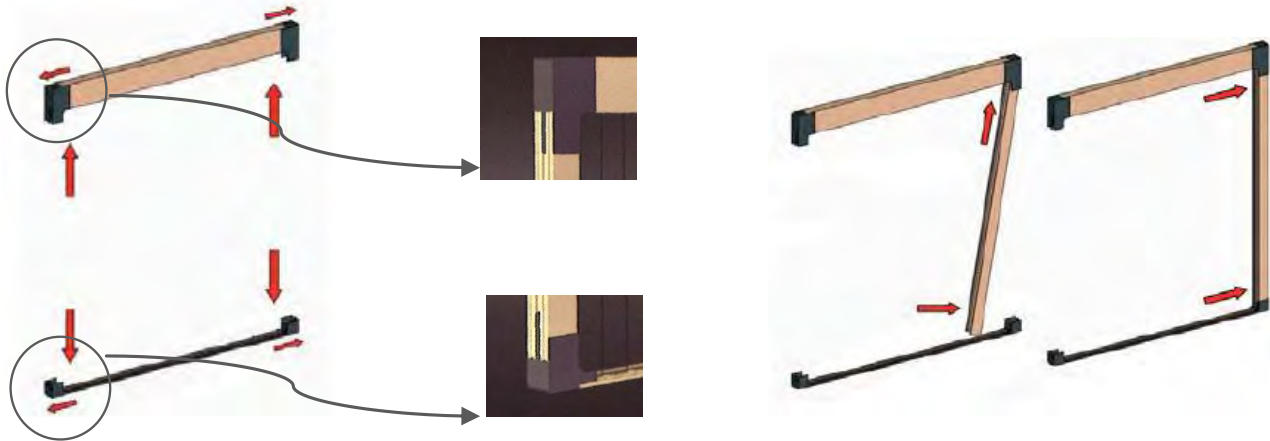

#### 2. Insertion and fastening of insect screen Kit

Insert the net packet inside the upper and lower profiles. Move the net packet towards the side guiding start profile. Insert the screen packet in the side profile until it locks in place (to the stop). Always start the inserting from the bottom.

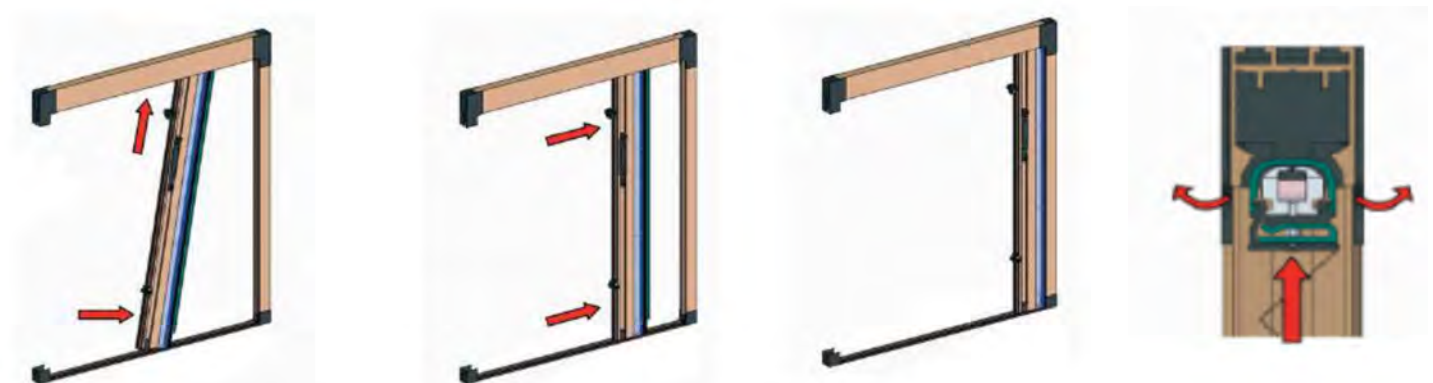

#### 3. tuner insertion

Insert the tuner in the appropriate angles, taking care to ensure that the heads of the tuner screws are always in sight and that the cords remain parallel (not crossed).

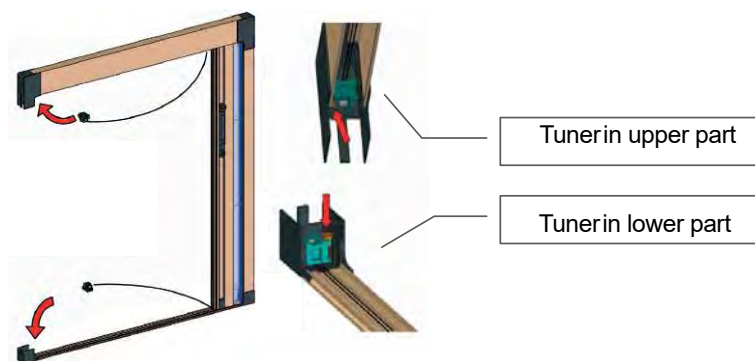

The cords have to lead out of the tuner on the opposite side of screws.

#### 4. Installation of guiding profile on the opposite site

Insert the sideguiding profile on the opposite site in the angles, by inserting the upper part first, then the lower part. Ensure that the holes for fastening then fasten using the screws provided.



#### 5. setting of cords

If necessary with the screwdriver provided activate the adjusting screw in the tuner, by turning it either to the left or right to set the tautness of the cords until a smooth flowing movement is obtained and the handle bar KIT is perfectly vertical.



#### 6. Insert the magnet channel

Check the polarity of the magnet channel and insert the magnet profile on the side profile.



#### 7. Plastic profile with spring

Insert plastic profile with spring of guides in the top profile KIT. Gently push the plastic part to the upper profile and tighten the screws. Plastic profile needs to elongate.

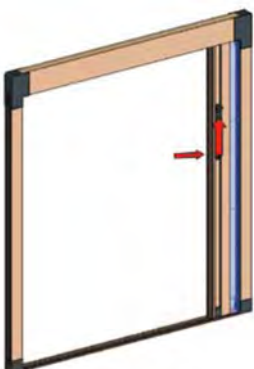

### 8. Handle

Insert the handle (optional part) then fastening with the screw. You can conveniently operate without handle.

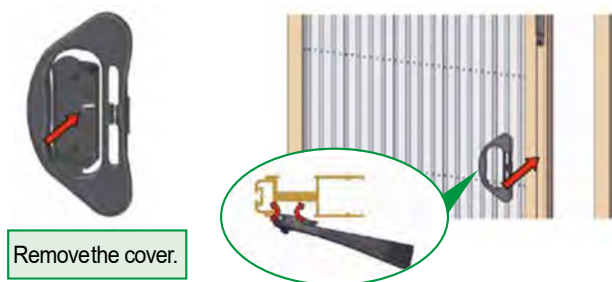

### 9. Guard insert

Insert the guard to the bottom frame KIT. For better guidance KIT in bottom profile.



### 10. Movement test

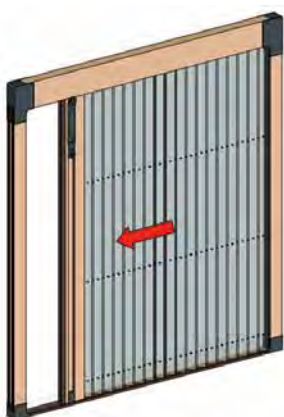

### 11. Disassembling (for cleaning)

Use the screw until the escaping of the screen pack.

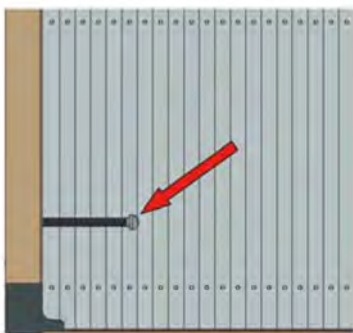



## Pleated insect screen PS2,PS2V

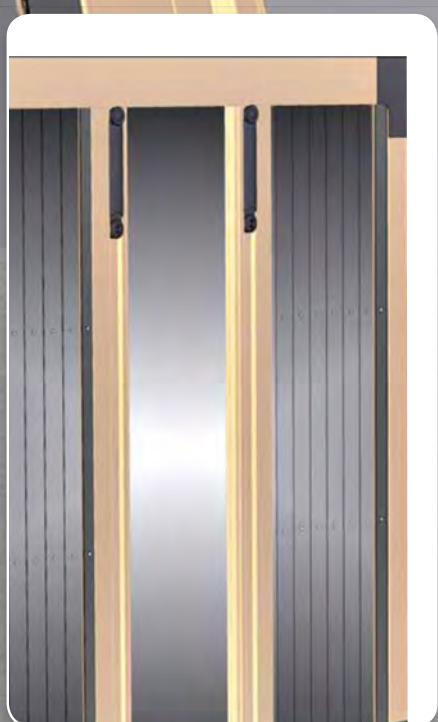

- ▲ Double-sided vertical
- ▲ 4 mm lower profile
- ▲ Huge dimensions
- ▲ Assembly into reveal and on the frame
- ▲ Modern design

**ISOTRA** *Quality*

## Pleated Insect screen Ps 2, Ps 2 V

### Basic Product Specification

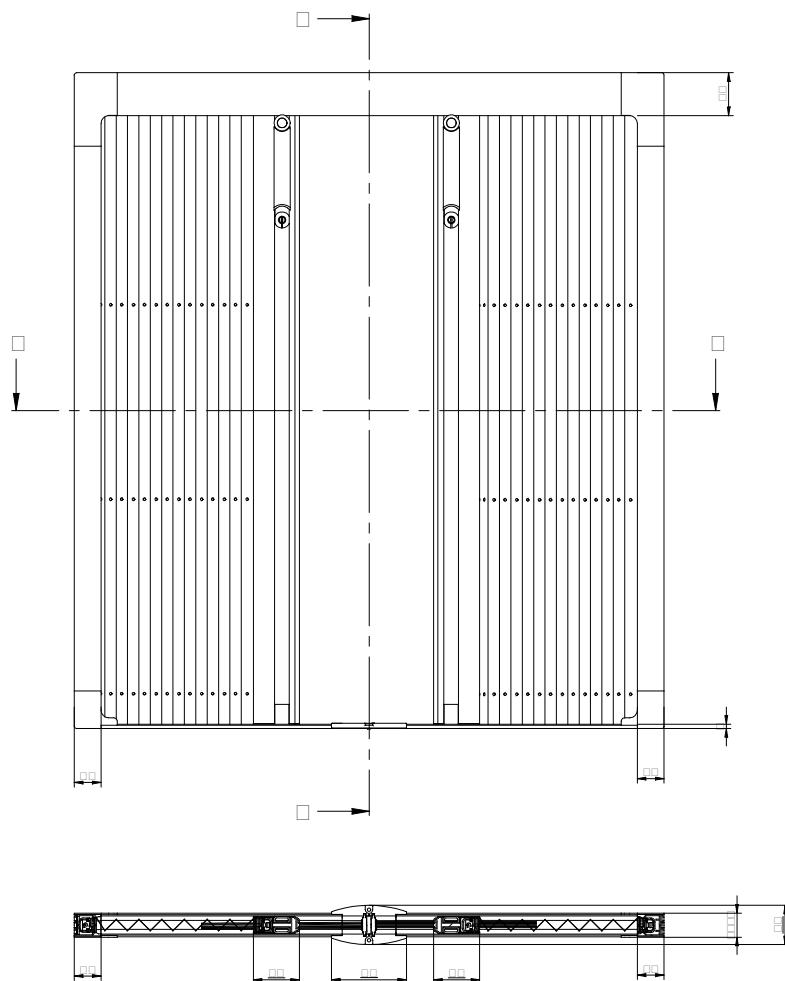

SECTION □□□□

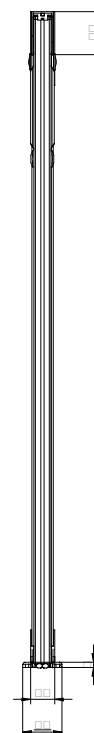

SECTION □□□□

2-01293-00VS (PS2)  
2-01295-20VS (PS2V)

### Limit dimensions

	Min. width (mm)	Max. width (mm)	Min. height (mm)	Max. height (mm)
PS2	1300	5000	1750	2750
PS2V*	1300	5000	2800	3400

\*nonstandard delivery

### standard colours Ps 2

Mesh	Frame	Plastic parts
Grey Black	RAL9010 White RAL1013 Ivory RAL8017 Brown RAL7016 Anthracite RAL6005 Green mat	White Black Brown Ivory

Note: other RAL and DECORAL colours for extra charge

### standard colours Ps 2 V

Mesh	Frame	Plastic parts
Grey Black	RAL9010 White RAL1013 Ivory RAL8017 Brown RAL7016 Anthracite RAL6005 Green mat	White Black Brown Ivory

Note: colour RAL7035 for extra charge

## Pleated insect screen Ps 2, Ps 2 V

### Profiles

Horizontal section

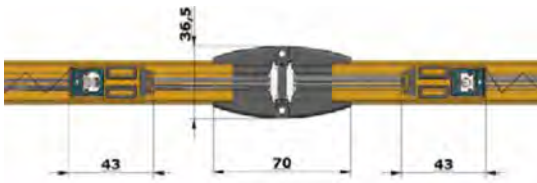

Vertical section

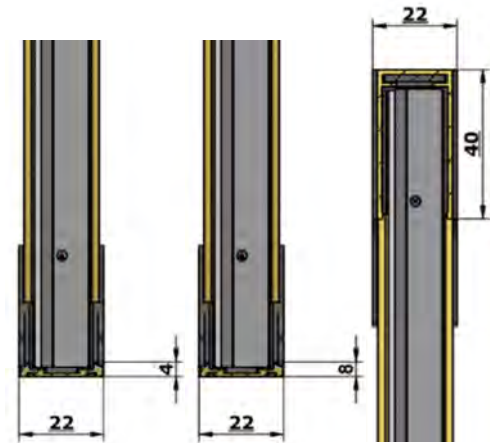

### Profiles into reveal

Lower profile 4mm SCPGI(6-013419-0000)

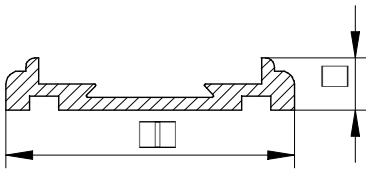

Profile AL-upper channel 40 mm SCPGS(6-013420-0000)

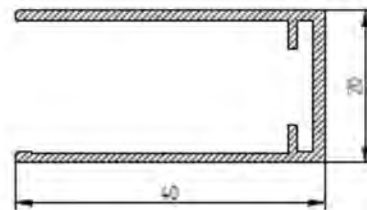

Magnet channel SCPPC(6-013463-0000)

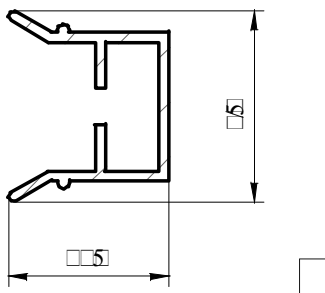

Profile AL-side start channel 25 mm SCPMP(6-013422-0000)

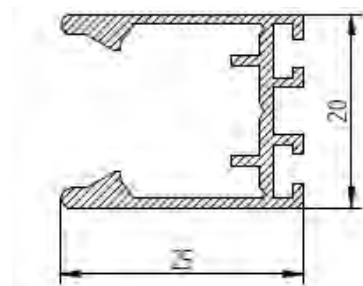

Movable channel SCPBA(6-013418-0000)

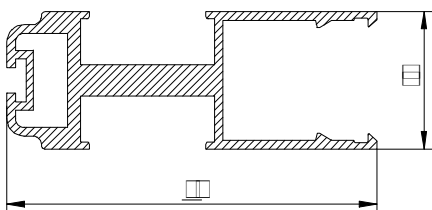

### Profiles on the frame

Profile AL-side channel 40 mm SCPMPT (6-013477-0000)

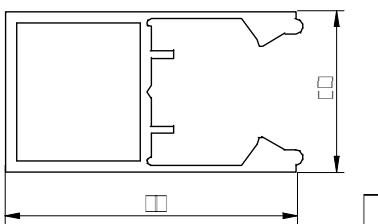

Profile AL-upper channel 40 mm SCPGT (6-013462-0000)

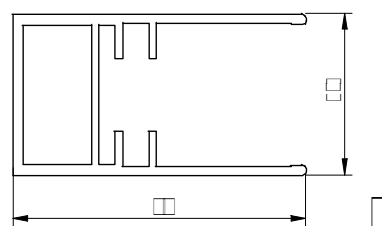



## Pleated insect screens Ps 2, Ps 2 V

### Assembly into reveal

#### 1. Profile installation

Place the plastic components on the upper and lower profile (see the details on below picture). Remove the protection of the double sticker and fix the upper and lower profile in the installation place. Correct any differences in length by sliding the angles pieces along. If you want to screw the lower profile the screws must have a countersunk head! Lower profile is combined from two parts connected with central plastic component.

Insert side guiding profile start to the plastic corner pieces. First, in the upper profile and consequently to the lower profile. Fix it using the enclosed screws.

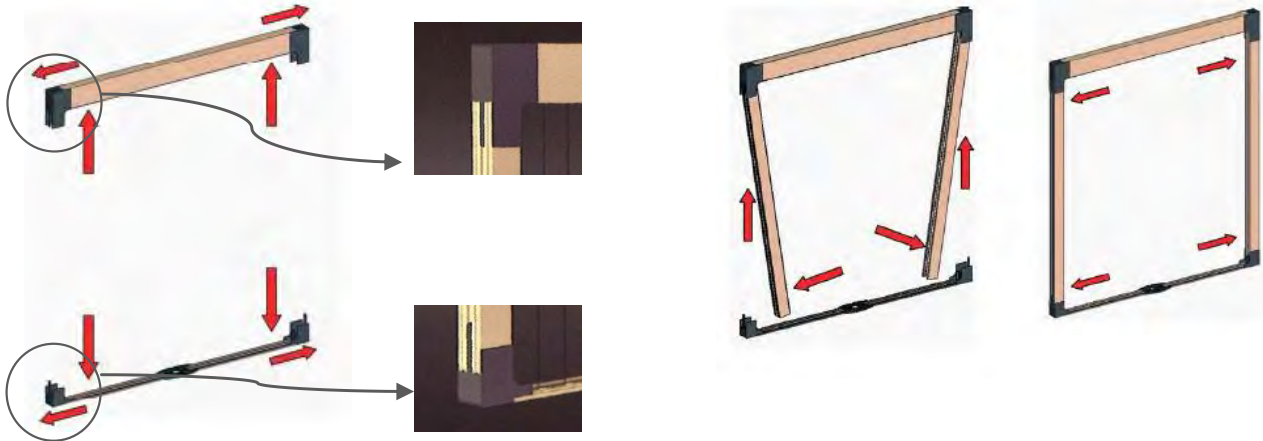

#### 2. Insertion and fastening of insect screen Kit

Insert both net packets KIT into upper and lower profiles. Move both packets with net towards the side guiding start profile. Insert both screen packets with net in the side profile until it locks in place (to the stop). Always start the inserting from the bottom.

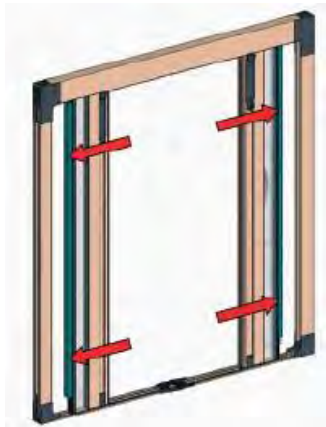

#### 3. Inserting the cord stops

At the bottom, insert the cord stops into their locations on the central plastic part (see detail). The lower cords are set in approximate lengths from production. In case of need it is necessary to tie up the knot. At the top, insert the knot on the cords into the respective location on each cursor (black plastic part). The cords from the right are inserted into the cursor on the left, and the cords from the left are inserted into the cursor on the right.

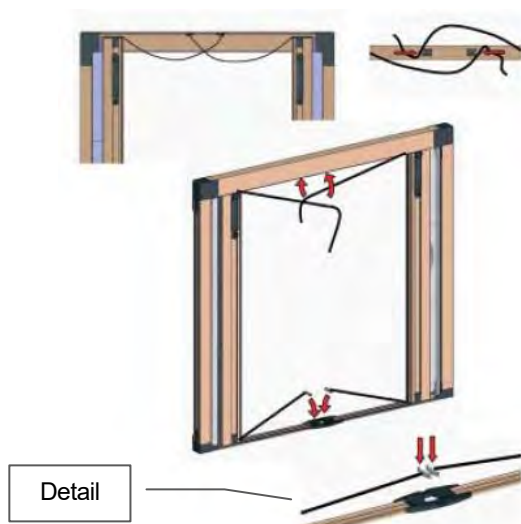

#### 4. cord adjustment

Using the key supplied, unscrew the screw on the cursors.

Tighten the cords by sliding each cursor, and then tighten the screws. Cut excess cord length after having completed adjustment.

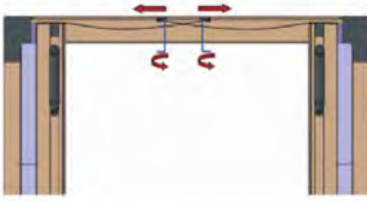

#### 5. Plastic parts with spring

Insert plastic profile with spring of guides in the top profile KIT. Gently push the plastic part to the upper profile and tighten the screws. Plastic profile needs to elongate.

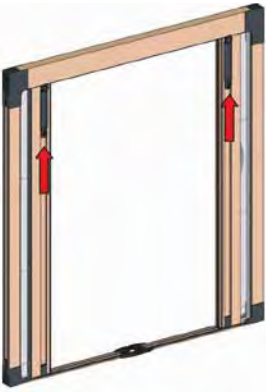

#### 6. sliding test

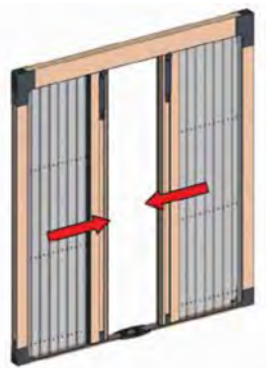

#### 7. complete the screen

Insert the cap supplied to hide the knot.



## Pleated insect screen Ps 1, Ps 1 V, Ps 2, Ps 2 V, Ps 3 V, Ps 4 V

### Measurement

#### Measurement into reveal

The width and the height of the hole clearance for inserting the screen are measured. Measurements are taken at three points, the lowest value is used.

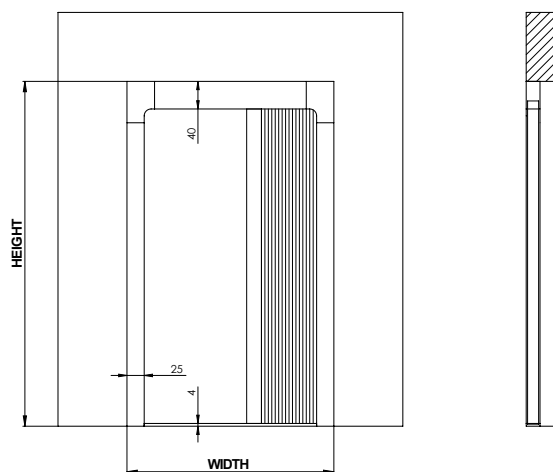

#### Measurement on the frame

Outside dimensions of insect screen are measured.

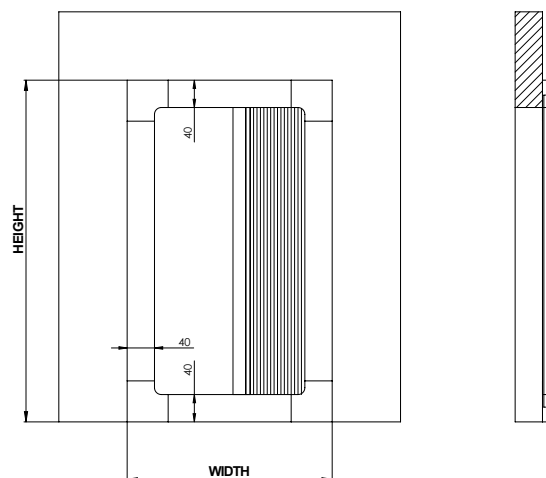

## Pleated insect screen Ps 4 V

### Measurement

#### Measurement into reveal

The width and the height of the hole clearance for inserting the screen are measured. Measurements are taken at three points, the lowest value is used.

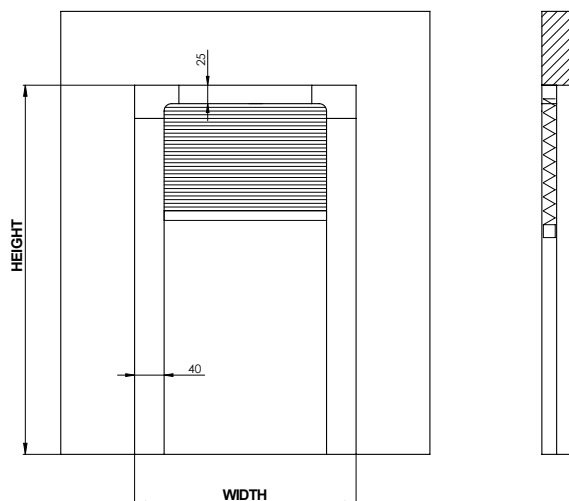

#### Measurement on the frame

Outside dimensions of insect screen are measured.

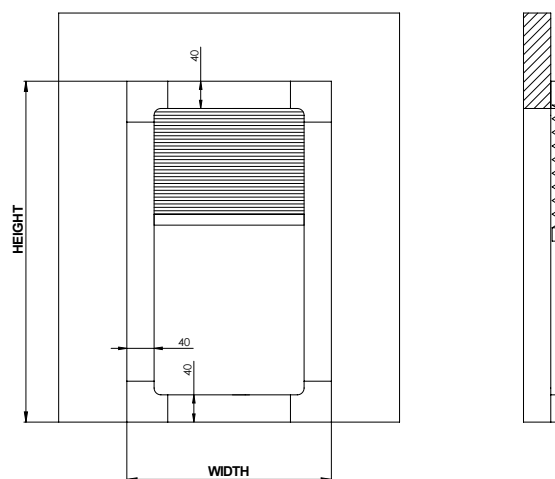

## Wound up of pleated insect screens (in the closed position):

Width of pleated insect screen	r rozměr nábalu*	
	Assembly into reveal	Assembly on the frame
do 700 mm	78 mm	79 mm
do 1000 mm	88 mm	89 mm
do 1300 mm	98 mm	99 mm
do 1800 mm	108 mm	109 mm
do 2800 mm	118 mm	119 mm

\*Size of pleated insect screen wound up includes the total width: start profile + insect screen + handling profile



## Pleated insect screen Ps 1, Ps 1 V, Ps 2, Ps 2 V, Ps 3 V, Ps 4 V

Assembly on the frame

1. Insert the bottom corner accessory on left „starting profile“.



2. Insert the top corner accessory on left „starting profile“.



3. Insert the upper track into the left top corner accessory.



4. Insert the top right corner component into upper profile.



5. Insert the right guiding profile into the plastic corner component.



6. Insert the bottom corner component into the side profile.



7. Fix the frame on the mounting spot according to pre-drilled holes.

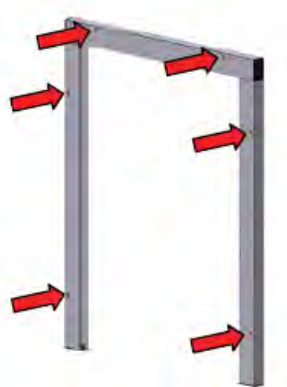

8. Position the lower profile on the right place of plastic corner components, fix it to the ground or supplied supportive Al profile.



9. Insert and fix the screen KIT.



10. Insert the plastic part at the end of cords into a hole in backpart of lower profile.

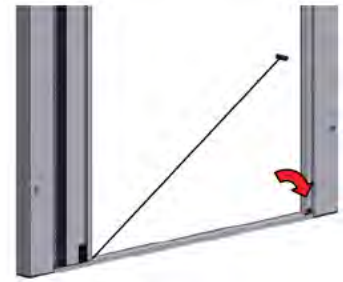

11. Insert wire node into the plastic block in upper profile and adjust the tension. The proper position of a block is approx. 1 cm from the side profile. If different then tie up the node.



12. Test the polarity of the „magnet profile“ then fix it to the „arrival profile“.

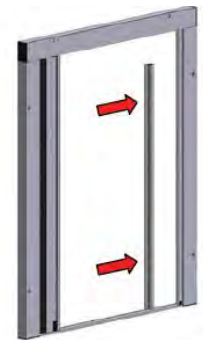

13. Open the screen mesh and check smooth movement.

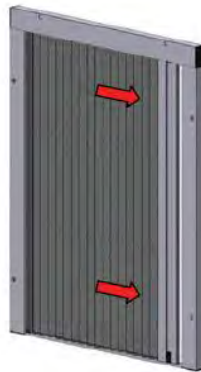

14. Insert the safety pin into the lower part of the frame KIT. For better sliding.



15. Insert the caps to cover the holes.

